

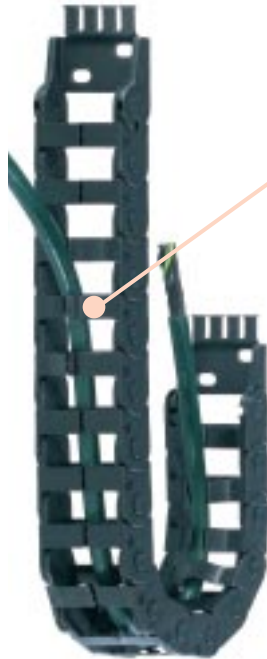

Price Index



4 Widths and
6 Bending Radii



Very easy to install cables and hoses - ideal for applications with pre-assembled connectors

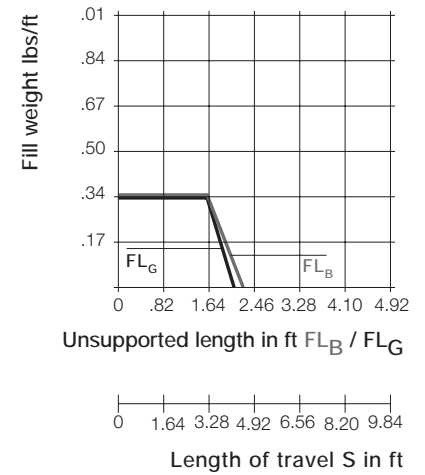

Mounting brackets with and without tiwrap plates



Quickfix: mounting bracket with dowel
Call for availability



Product range:

Inner Widths (Bi) inches (mm):	.59 (15), .98 (25), 1.50 (38), 1.97 (50)
Bending Radii (R) inches (mm):	1.10 (028), 1.50 (038), 1.89 (048), 2.95 (075), 3.94 (100), 4.92 (125)
Pitch:	1.20 (30.5 mm)/link= 10.06 links/ft (33 link/m) 39.6 in. (1006.5 mm)

Unsupported length

- FL_B = unsupported with permitted sag
- FL_G = unsupported with straight upper run

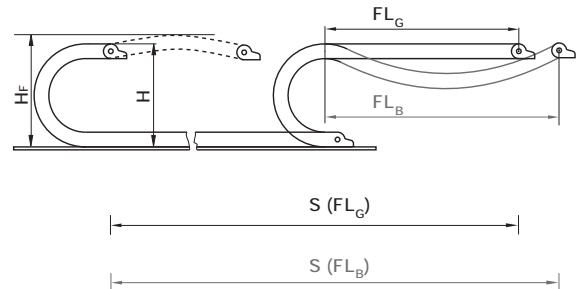

When to use the Series E14/Z14:

- If price is an issue
- If fast and easy cable and hose accessibility is required
- If torsional rigidity and torque resistance are required
- If very quiet operation is required



When not to use the Series E14/Z14:

- If a long unsupported length is required
▶ Series B15, Chapter 4
- "Z" Series is unsuitable for gliding applications
▶ Series B15, Chapter 4

[Click Here for Specs & CAD Files](#)

Series E14/Z14 "E-Z Chain"



E14
Z14

E14 (split crossbar along outer radius)

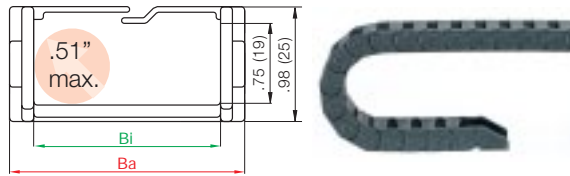

Part No.	Bi	Ba	Bending Radii for ALL Widths	
E14-1	.59 (15)	1.06 (27)		1.10 (028)
E14-2	.98 (25)	1.46 (37)		1.50 (038)
E14-3	1.50 (38)	1.97 (50)		1.89 (048)
E14-4	1.97 (50)	2.44 (62)		2.95 (075)
			3.94 (100)	
			4.92 (125)	

Supplement part number with required radius
for example, E14-2-028-0

Z14 (split crossbar along inner radius)

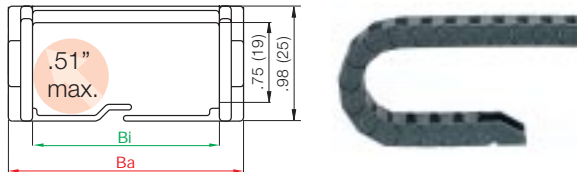

Part No.	Bi	Ba	Bending Radii for ALL Widths	
Z14-1	.59 (15)	1.06 (27)		1.10 (028)
Z14-2	.98 (25)	1.46 (37)		1.50 (038)
Z14-3	1.50 (38)	1.97 (50)		1.89 (048)
Z14-4	1.97 (50)	2.44 (62)		2.95 (075)
			3.94 (100)	
			4.92 (125)	

Supplement part number with required radius
for example, Z14-2-028-0

Installation Dimensions

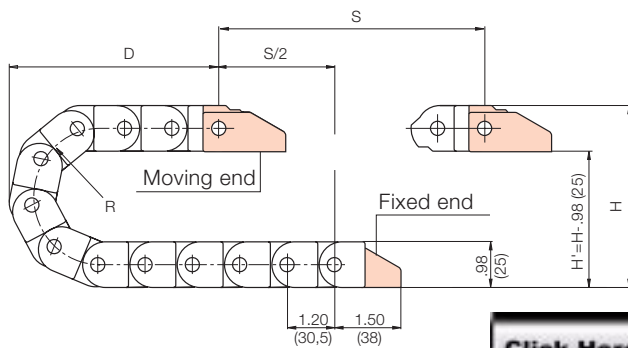

	1.10 (028)	1.50 (038)	1.89 (048)
R	1.10 (028)	1.50 (038)	1.89 (048)
H	3.23 (82)	4.02 (102)	4.80 (122)
D	2.79 (71)	3.19 (81)	3.58 (91)
K	5.91 (150)	7.28 (185)	8.46 (215)

	2.95 (075)	3.94 (100)	4.92 (125)
R	2.95 (075)	3.94 (100)	4.92 (125)
H	6.97 (177)	8.94 (227)	10.90 (277)
D	4.72 (120)	5.71 (145)	6.69 (170)
K	11.81 (300)	14.76 (375)	17.91 (455)

*The required clearance height is HF = H + .39 (10) with .13 lbs/ft (0.2 kg/m) fill weight. Please consult igus® if space is particularly restricted.

- Pitch: = 1.20 (30.5 mm) per link
- Links per ft (m): = 10.06 (33)
- Chain length: = $\frac{S}{2} + K$



Mounting Brackets

- Option 1: Without tiewrap plate
- Option 2: With tiewrap plate

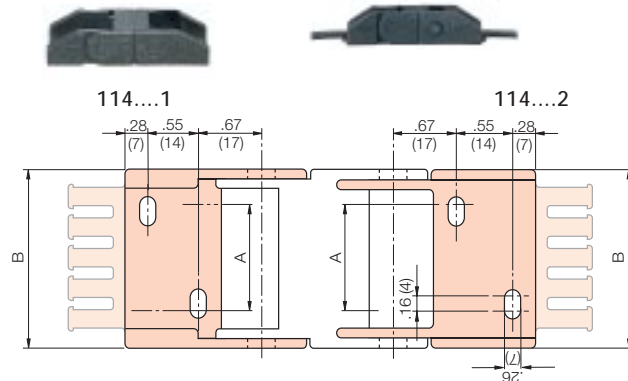

Standard mounting bracket

- One-piece, locking bracket
- Corrosion-resistant
- Available pre-assembled
- Inner and outer attachment possible
- Available with integrated strain relief tiewrap plate

Chain Type	Part No. Set Full Set with Tiewrap Plate	Part No. Mounting Bracket Set	Dimension A in. (mm)	Dimensions B in. (mm)
E14/Z14-1	114-1-12PZ	114-1-12P	—	1.02 (26)
E14/Z14-2	114-2-12PZ	114-2-12P	.39 (10)	1.42 (36)
E14/Z14-3	114-3-12PZ	114-3-12P	.91 (23)	1.93 (49)
E14/Z14-4	114-4-12PZ	114-4-12P	1.38 (35)	2.40 (61)

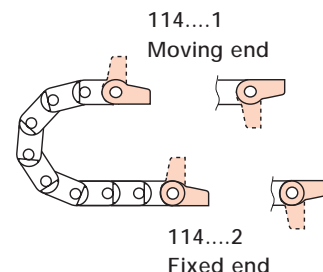

- 114...12 = Full set, each part with pin/bore
- 114... 1 = Mounting bracket with bore
- 114... 2 = Mounting bracket with pin

PDF: www.igus.com/echainpdf.asp
Specs/CAD/RFO: www.igus.com/echain.asp
RoHS info: www.igus.com/RoHS.asp



Order example

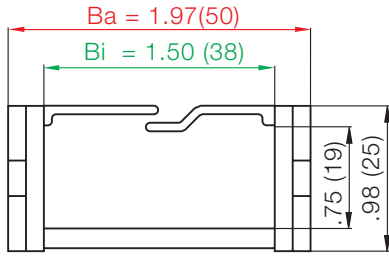

E14-3

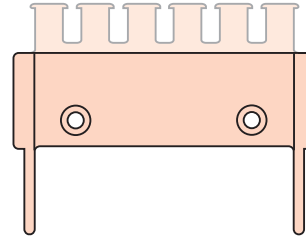

1. Chain selection:

E14-3-038-0



2. Mounting brackets:

114-3-12 PZ - With strain relief tiwrap plate



For 2.62 ft (0.8 m) chain, color black, with mounting brackets:

2.62 ft (0.8 m) E14-3-038-0 and 114-3-12PZ



Technical data

Chain Type	Weight Per Link		Weight	
	(oz.)	(g)	(lbs/ft)	(kg/m)
E14-1/Z14-1	0.032	(≈ 0.93)	0.208	(≈ 0.31)
E14.2/Z14-2	0.033	(≈ 0.96)	0.215	(≈ 0.32)
E14-3/Z14-3	0.042	(≈ 1.20)	0.269	(≈ 0.40)
E14-4/Z14-4	0.047	(≈ 1.33)	0.296	(≈ 0.44)

Material (chain)	igumid NB
Material (mounting brackets)*	igumid G
Permitted temperature	-22°F/212°F (-30°C/+100°C)
Gliding speed max.	Conditionally suitable
Unsupported v max.	32.8 ft/s (10m/s)
Flammability class (chain)	VDE 0304 IIC UL94 V2
Flammability class (mounting brackets)*	VDE 0304 IIC UL94 HB

*Available in igumid NB upon request, please consult igus® for delivery time

- Details of material properties
- ▶ Design, Chapter 1