

igus[®]



iglide[®] G300

Product Range

- Standard Styles:
Sleeve, Flange and Thrust Washer
- Custom shapes and sizes available
- Inner diameters:
Inch sizes from 1/8 - 3 in.
Metric sizes from 1.5 - 150 mm

Part Number Structure

Part Number Structure

G S I-02 03-03

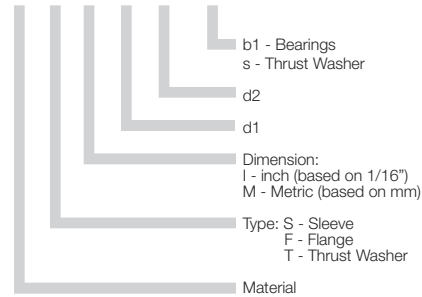

Permissible Surface Speeds

	Continuous fpm	Short Term fpm
Rotating	196	393
Oscillating	137	275
Linear	787	984

Usage Guidelines



- When you need an economical all-around performance bearing
- For above average loads
- For low to average running speeds
- When the bearing needs to run on different shaft materials
- For oscillating and rotating movements



- When mechanical reaming of the wall surface is necessary
➤ iglide® M250
- When the highest wear resistance is necessary
➤ iglide® L280
- If temperatures are constantly greater than +266°F
➤ iglide® T500, F, Z



Visit www.igus.com
to use our online
expert system

Material Data

General Properties	Unit	iglide® G300	Testing Method
Density	g/cm ³	1.46	
Color		dark gray	
Max. moisture absorption at 73°F / 50% r.h.	% weight	0.7	DIN 53495
Max. moisture absorption	% weight	4.0	
Coefficient of friction, dynamic against steel	μ	0.08 - 0.15	
p x v-value, max. (dry)	psi x fpm	12,000	

Mechanical Properties

Modulus of elasticity	psi	1,131,000	DIN 53457
Tensile strength at 68°F	psi	30,460	DIN 53452
Compressive strength	psi	11,310	
Max. static surface pressure (68°F)	psi	11,600	
Shore D-hardness		81	DIN 53505

Physical and Thermal Properties

Max. long-term application temperature	°F	266	
Max. short-term application temperature	°F	428	
Min. application temperature	°F	-40	
Thermal conductivity	(W/m x K)	0.24	ASTM C 177
Coefficient of thermal expansion (at 73°F)	(K ⁻¹ x 10 ⁻⁵)	9	DIN 53752

Electrical Properties

Specific volume resistance	Ωcm	> 10 ¹³	DIN IEC 93
Surface resistance	Ω	> 10 ¹¹	DIN 53482

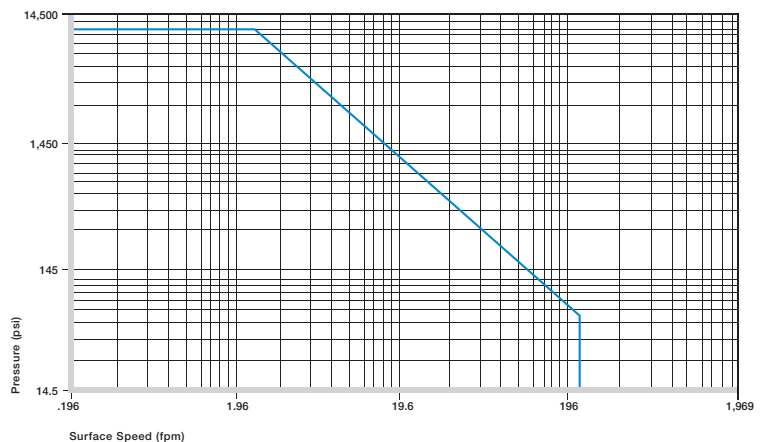

Permissible p x v - values for iglide® G300 running dry against a steel shaft, at 68°F

Compressive Strength

The graph shows the elastic deformation of iglide® G300 during radial loading. At the maximum permissible load of 11,600 psi, the deformation is less than 5%. The plastic deformation is minimal up to a pressure of approximately 14,500 psi. However, it is also a result of the cycle time.

► Compressive Strength, Page 1.3

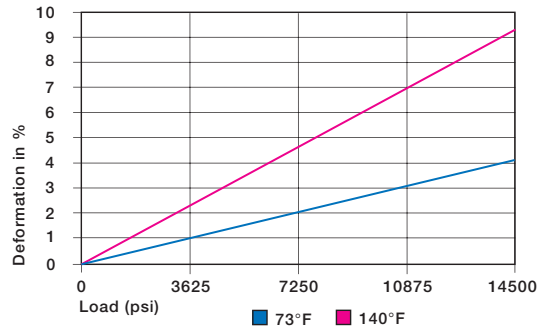

Deformation under load and temperature

Permissible Surface Speeds

iglide® G300 has been developed for low to medium surface speeds. The maximum values shown in the table can only be achieved at low pressure loads. At the given speeds, friction can cause a temperature increase to maximum permissible levels. In practice, though, this temperature level is rarely reached, due to varying application conditions.

- Surface speed, Page 1.5
- p x v Value, Page 1.6

	Continuous fpm	Short Term fpm
Rotating	196	393
Oscillating	137	275
Linear	787	984

Maximum running speed

Temperatures

Application temperatures affect the properties of plain bearings greatly. The short-term maximum temperature is 428°F, this allows the use of iglide® G300 plain bearings in heat treating applications in which the bearings are not subjected to additional loading.

With increasing temperatures, the compressive strength of iglide® G300 plain bearings decreases. The graph shows this inverse relationship. However, at the long-term maximum temperature of 266°F, the permissible surface pressure is still above 5,800 psi. The ambient temperatures that are prevalent in applications also has an effect on the bearing wear. With increasing temperatures, the wear increases and this effect is notable starting at the temperature of 248°F.

► Application Temperatures, Page 1.7

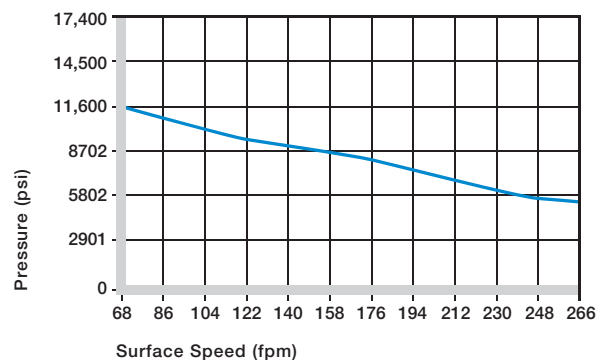

Recommended maximum permissible static surface pressure of iglide® G300 as a result of temperature

iglide® G300	Application Temperature
Minimum	-40 °F
Max. long-term	+266 °F
Max. short-term	+428 °F
Additional axial securing	+212°F

Temperature limits for iglide® G300

iglide® G300

PDF: www.igus.com/iglide-pdfs
CAD: www.igus.com/iglide-CAD
RoHS info: www.igus.com/RoHS

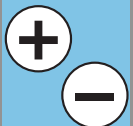

Installation Tolerances

iglide® G300 plain bearings are oversized before being pressfit. After proper installation into a recommended housing bore, the inner diameter adjusts to meet our specified tolerances. Please adhere to the catalog specifications for housing bore and recommended shaft sizes. This will help to ensure optimal performance of iglide® plain bearings.

- See Tolerance Table, Page 1.14
- Testing Methods, Page 1.15

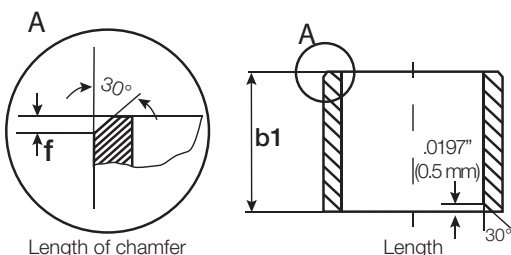

For Inch Size Bearings		
Length Tolerance (b1)		Length of Chamfer (f)
Length (inches)	Tolerance (h13) (inches)	Based on d1
0.1181 to 0.2362	-0.0000 /-0.0071	f = .012 → d ₁ .040" - .236"
0.2362 to 0.3937	-0.0000 /-0.0087	f = .019 → d ₁ > .236" - .472"
0.3937 to 0.7086	-0.0000 /-0.0106	f = .031 → d ₁ > .472" - 1.18"
0.7086 to 1.1811	-0.0000 /-0.0130	f = .047 → d ₁ > 1.18"
1.1811 to 1.9685	-0.0000 /-0.0154	
1.9685 to 3.1496	-0.0000 /-0.0181	

For Metric Size Bearings		
Length Tolerance (b1)		Length of Chamfer (f)
Length (mm)	Tolerance (h13) (µm)	Based on d1
1 to 3	-0 /-140	f = 0.3 → d ₁ 1 - 6 mm
> 3 to 6	-0 /-180	f = 0.5 → d ₁ > 6 - 12 mm
> 6 to 10	-0 /-220	f = 0.8 → d ₁ > 12 - 30 mm
> 10 to 18	-0 /-270	
> 18 to 30	-0 /-330	
> 30 to 50	-0 /-390	
> 50 to 80	-0 /-460	

Friction and Wear

Similar to wear resistance, the coefficient of friction μ also changes with the load. The coefficient of friction decreases with increasing loads, whereas an increase in surface speed causes an increase of the coefficient of friction. This relationship explains the excellent results of iglide® G300 plain bearings for high loads and low speeds.

The friction and wear are also dependent, to a large degree, on the shaft partner. Shafts that are too smooth, increase both the coefficient of friction and the wear of the bearing. For iglide® G300, a ground surface with an average roughness Ra= 32 rms is recommended.

- Coefficients of friction and surfaces, Page 1.8
- Wear Resistance, Page 1.9

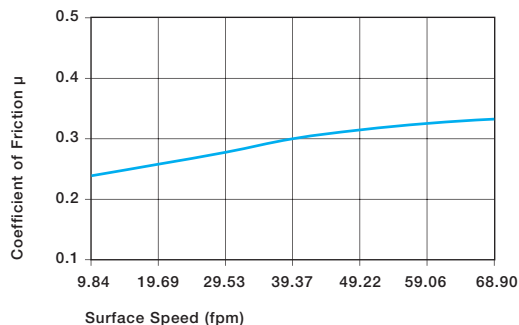

Coefficient of friction of iglide® G300 as a result of the running speed; p = 108 psi

iglide® G300	Coefficient of Friction
Dry	0.08 - 0.15
Grease	0.09
Oil	0.04
Water	0.04

Coefficient of friction for iglide® G300 against steel (Shaft finish = 40 rms, 50 HRC)

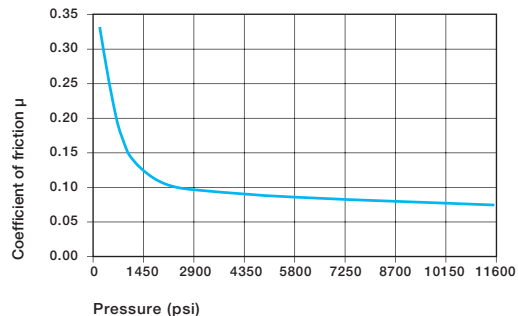

Coefficient of friction of iglide® G300 as a result of the load, v = 1.96 fpm

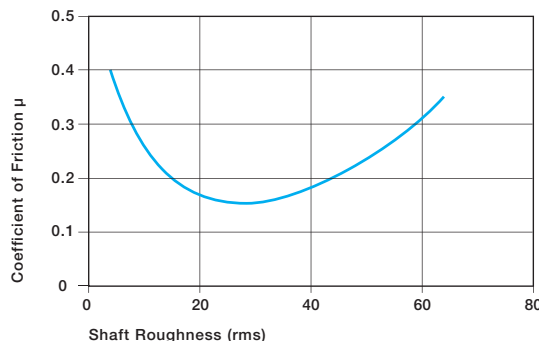

Coefficient of friction as result of the shaft surface (Shaft - 1050 hard chromed)

Shaft Materials

The graphs show results of testing different shaft materials with plain bearings made of iglide® G300.

In the graph below it is observed that iglide® G300 can be combined with various shaft materials. The simple shaft materials of free-cutting steel and HR Carbon Steel have proven best at low loads. This helps to design cost-effective systems, since both iglide® G300 and the sliding partner are economically priced.

It is important to note that with increasing loads, the recommended hardness of the shaft increases. The “soft” shafts tend to wear more easily and thus increase the wear of the overall system. If the loads exceed 290 psi, it is important to recognize that the wear rate (the slope of the curves) clearly decreases with the hard shaft materials.

The comparison of rotational movements to oscillating movements shows that iglide® G300 can provide advantages in oscillating movements. The wear of the bearing is smaller for equivalent conditions. The higher the load, the larger the difference. This means that iglide® G300 can be used for oscillating movements that are well above the given maximum load of 11,600 psi. For these loads, the use of hardened shafts is recommended. In addition to the shaft materials presented here, many others have been tested. If the shaft material you plan on using is not contained in the test results presented here, please contact us.

► Shaft Materials, Page 1.11

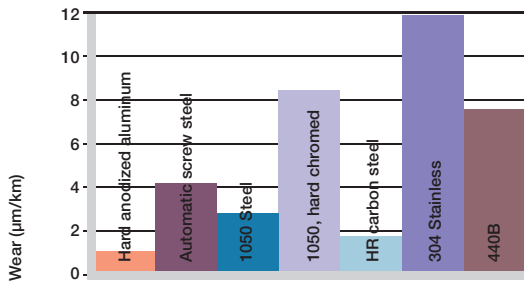

Wear of iglide® G300, rotating with different shaft materials, load p = 145 psi, v = 59 fpm

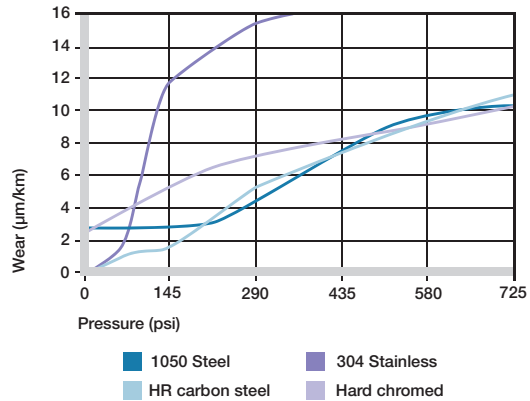

Wear with different shaft materials in rotational operation, as a result of the load

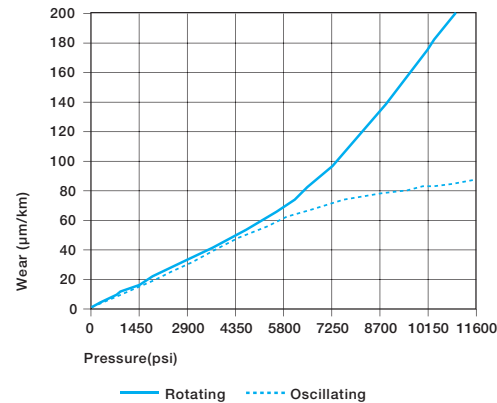

Wear for pivoting and rotating applications with shaft material 1050 hard chromed, as a result of the load

Chemical & Moisture Resistance

iglide® G300 plain bearings have strong resistance to chemicals. They are also resistant to most lubricants.

iglide® G300 plain bearings are not affected by most weak organic and inorganic acids.

The moisture absorption of iglide® G300 plain bearings is approximately 1% in the standard atmosphere. The saturation limit submerged in water is 4%. This must be taken into account for these types of applications.

► Chemicals Table, Page 1.16

Medium	Resistance
Alcohol	+ to 0
Hydrocarbon	+
Greases, oils without additives	+
Fuels	+
Weak acids	0 to -
Strong acids	-
Weak alkaline	+
Strong alkaline	0

+ resistant, 0 conditionally resistant, - not resistant

Chemical resistance of iglide® G300

All data given concerns the chemical resistance at room temperature (68°F). For a complete list, see page 1.16

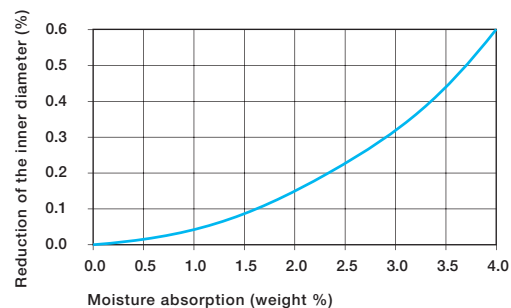

Effect of moisture absorption on iglide® G300 plain bearings

Radiation Resistance

Plain bearings made from iglide® G300 are resistant to radiation up to an intensity of 3×10^2 Gy.

UV Resistance

iglide® G300 plain bearings are permanently resistant to UV-radiation.

Vacuum

iglide® G300 plain bearings outgas in a vacuum. Use in a vacuum environment is only possible for dehumidified bearings.

Electrical Properties

iglide® G300 plain bearings are electrically insulating.

iglide® G300

Specific volume resistance	> 10^{13} Ωcm
Surface resistance	> 10^{11} Ω

Electrical properties of iglide® G300

Application Examples



Reliable under high load, wear-resistant during continuous rotational use



Tested at a load of 4046 lbs for 10,000 cycles, resulted in no measurable wear



The pneumatic rotational drive unit in steam lines at temperatures up to 275°F



Vibrations, dirt, and temperatures up to 266°F characterize the area surrounding the engine



Conveyor chains: Through edge loading, short-term surface pressures of over 7,250 psi can occur



iglide® G300 plain bearings have proven themselves in control levers and pedals of farm tractors and construction vehicles

iglide® Plain Bearings G300 - Sleeve Bearing, Inch



G300

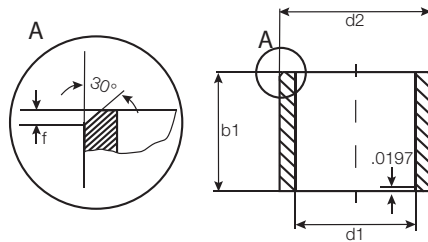

For tolerance values
please refer to page 6.4

iglide® G300
Sleeve - Inch

Part Number	d1	d2	b1	I.D. After Pressfit		Housing Bore		Shaft Size	
				Max.	Min.	Max.	Min.	Max.	Min.
GSI-0203-03	1/8	3/16	3/16	.1269	.1251	.1878	.1873	.1243	.1236
GSI-0203-04	1/8	3/16	1/4	.1269	.1251	.1878	.1873	.1243	.1236
GSI-0203-06	1/8	3/16	3/8	.1269	.1251	.1878	.1873	.1243	.1236
GSI-0304-04	3/16	1/4	1/4	.1892	.1873	.2503	.2497	.1865	.1858
GSI-0304-06	3/16	1/4	3/8	.1892	.1873	.2503	.2497	.1865	.1858
GSI-0304-08	3/16	1/4	1/2	.1892	.1873	.2503	.2497	.1865	.1858
GSI-0405-04	1/4	5/16	1/4	.2521	.2498	.3128	.3122	.2490	.2481
GSI-0405-05	1/4	5/16	5/16	.2521	.2498	.3128	.3122	.2490	.2481
GSI-0405-06	1/4	5/16	3/8	.2521	.2498	.3128	.3122	.2490	.2481
GSI-0405-08	1/4	5/16	1/2	.2521	.2498	.3128	.3122	.2490	.2481
GSI-0405-10	1/4	5/16	5/8	.2521	.2498	.3128	.3122	.2490	.2481
GSI-0405-12	1/4	5/16	3/4	.2521	.2498	.3128	.3122	.2490	.2481
GSI-0506-04	5/16	3/8	1/4	.3148	.3125	.3753	.3747	.3115	.3106
GSI-0506-06	5/16	3/8	3/8	.3148	.3125	.3753	.3747	.3115	.3106
GSI-0506-08	5/16	3/8	1/2	.3148	.3125	.3753	.3747	.3115	.3106
GSI-0506-12	5/16	3/8	3/4	.3148	.3125	.3753	.3747	.3115	.3106
GSI-0607-04	3/8	15/32	1/4	.3773	.3750	.4691	.4684	.3740	.3731
GSI-0607-06	3/8	15/32	3/8	.3773	.3750	.4691	.4684	.3740	.3731
GSI-0607-08	3/8	15/32	1/2	.3773	.3750	.4691	.4684	.3740	.3731
GSI-0607-12	3/8	15/32	3/4	.3773	.3750	.4691	.4684	.3740	.3731
GSI-0608-08	3/8	1/2	1/2	.3783	.3760	.5015	.5010	.3750	.3741
GSI-0608-12	3/8	1/2	3/4	.3783	.3760	.5015	.5010	.3750	.3741
GSI-0708-04	7/16	17/32	1/4	.4406	.4379	.5316	.5309	.4365	.4355
GSI-0708-08	7/16	17/32	1/2	.4406	.4379	.5316	.5309	.4365	.4355
GSI-0809-03	1/2	19/32	3/16	.5030	.5003	.5941	.5934	.4990	.4980
GSI-0809-04	1/2	19/32	1/4	.5030	.5003	.5941	.5934	.4990	.4980
GSI-0809-06	1/2	19/32	3/8	.5030	.5003	.5941	.5934	.4990	.4980
GSI-0809-08	1/2	19/32	1/2	.5030	.5003	.5941	.5934	.4990	.4980
GSI-0809-10	1/2	19/32	5/8	.5030	.5003	.5941	.5934	.4990	.4980
GSI-0809-12	1/2	19/32	3/4	.5030	.5003	.5941	.5934	.4990	.4980
GSI-0809-14	1/2	19/32	7/8	.5030	.5003	.5941	.5934	.4990	.4980
GSI-0809-16	1/2	19/32	1	.5030	.5003	.5941	.5934	.4990	.4980
GSI-0810-08	1/2	5/8	1/2	.5040	.5013	.6260	.6250	.5000	.4990
GSI-0810-12	1/2	5/8	3/4	.5040	.5013	.6260	.6250	.5000	.4990
GSI-0910-06	9/16	21/32	3/8	.5655	.5627	.6566	.6559	.5615	.5605
GSI-0910-08	9/16	21/32	1/2	.5655	.5627	.6566	.6559	.5615	.5605
GSI-0910-10	9/16	21/32	5/8	.5655	.5627	.6566	.6559	.5615	.5605
GSI-1011-06	5/8	23/32	3/8	.6280	.6253	.7192	.7184	.6240	.6230
GSI-1011-08	5/8	23/32	1/2	.6280	.6253	.7192	.7184	.6240	.6230
GSI-1011-10	5/8	23/32	5/8	.6280	.6253	.7192	.7184	.6240	.6230
GSI-1011-12	5/8	23/32	3/4	.6280	.6253	.7192	.7184	.6240	.6230
GSI-1011-16	5/8	23/32	1	.6280	.6253	.7192	.7184	.6240	.6230

PDF: www.igus.com/iglide-pdfs
CAD: www.igus.com/iglide-CAD
RoHS info: www.igus.com/RoHS

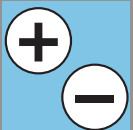

iglide® G300
Sleeve - Inch

Telephone 1-800-521-2747
Fax 1-401-438-7270

Internet: <http://www.igus.com>
email: sales@igus.com
QuickSpec: <http://www.igus.com/iglide-quickspec>

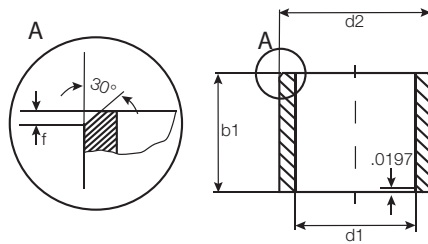

For tolerance values
please refer to page 6.4

Part Number	d1	d2	b1	I.D. After Pressfit		Housing Bore		Shaft Size	
				Max.	Min.	Max.	Min.	Max.	Min.
GSI-1011-20	5/8	23/32	1 1/4	.6280	.6253	.7192	.7184	.6240	.6230
GSI-1011-30	5/8	23/32	1 7/8	.6280	.6253	.7192	.7184	.6240	.6230
GSI-1012-08	5/8	3/4	1/2	.6280	.6253	.7508	.7500	.6250	.6233
GSI-1012-16	5/8	3/4	1	.6280	.6253	.7508	.7500	.6250	.6233
GSI-1112-14	11/16	25/32	7/8	.6906	.6879	.7817	.7809	.6865	.6855
GSI-1214-02	3/4	7/8	1/8	.7541	.7508	.8755	.8747	.7491	.7479
GSI-1214-06	3/4	7/8	3/8	.7541	.7508	.8755	.8747	.7491	.7479
GSI-1214-08	3/4	7/8	1/2	.7541	.7508	.8755	.8747	.7491	.7479
GSI-1214-12	3/4	7/8	3/4	.7541	.7508	.8755	.8747	.7491	.7479
GSI-1214-16	3/4	7/8	1	.7541	.7508	.8755	.8747	.7491	.7479
GSI-1214-20	3/4	7/8	1 1/4	.7541	.7508	.8755	.8747	.7491	.7479
GSI-1214-24	3/4	7/8	1 1/2	.7541	.7508	.8755	.8747	.7491	.7479
GSI-1416-06	7/8	1	3/8	.8791	.8757	1.0005	.9997	.8741	.8729
GSI-1416-08	7/8	1	1/2	.8791	.8757	1.0005	.9997	.8741	.8729
GSI-1416-10	7/8	1	5/8	.8791	.8757	1.0005	.9997	.8741	.8729
GSI-1416-12	7/8	1	3/4	.8791	.8757	1.0005	.9997	.8741	.8729
GSI-1416-16	7/8	1	1	.8791	.8757	1.0005	.9997	.8741	.8729
GSI-1416-24	7/8	1	1 1/2	.8791	.8757	1.0005	.9997	.8741	.8729
GSI-1618-08	1	1 1/8	1/2	1.0041	1.0007	1.1255	1.1247	.9991	.9979
GSI-1618-12	1	1 1/8	3/4	1.0041	1.0007	1.1255	1.1247	.9991	.9979
GSI-1618-16	1	1 1/8	1	1.0041	1.0007	1.1255	1.1247	.9991	.9979
GSI-1618-20	1	1 1/8	1 1/4	1.0041	1.0007	1.1255	1.1247	.9991	.9979
GSI-1618-24	1	1 1/8	1 1/2	1.0041	1.0007	1.1255	1.1247	.9991	.9979
GSI-1618-33	1	1 1/8	2 1/16	1.0041	1.0007	1.1255	1.1247	.9991	.9979
GSI-1820-12	1 1/8	1 9/32	3/4	1.1288	1.1254	1.2818	1.2808	1.1238	1.1226
GSI-1820-20	1 1/8	1 9/32	1 1/4	1.1288	1.1254	1.2818	1.2808	1.1238	1.1226
GSI-1820-24	1 1/8	1 9/32	1 1/2	1.1288	1.1254	1.2818	1.2808	1.1238	1.1226
GSI-2022-12	1 1/4	1 13/32	3/4	1.2548	1.2508	1.4068	1.4058	1.2488	1.2472
GSI-2022-14	1 1/4	1 13/32	7/8	1.2548	1.2508	1.4068	1.4058	1.2488	1.2472
GSI-2022-16	1 1/4	1 13/32	1	1.2548	1.2508	1.4068	1.4058	1.2488	1.2472
GSI-2022-20	1 1/4	1 13/32	1 1/4	1.2548	1.2508	1.4068	1.4058	1.2488	1.2472
GSI-2022-24	1 1/4	1 13/32	1 1/2	1.2548	1.2508	1.4068	1.4058	1.2488	1.2472
GSI-2224-16	1 3/8	1 17/32	1	1.3798	1.3758	1.5318	1.5308	1.3738	1.3722
GSI-2224-24	1 3/8	1 17/32	1 1/2	1.3798	1.3758	1.5318	1.5308	1.3738	1.3722
GSI-2224-26	1 3/8	1 17/32	1 5/8	1.3798	1.3758	1.5318	1.5308	1.3738	1.3722
GSI-2426-06	1 1/2	1 21/32	3/8	1.5048	1.5008	1.6568	1.6558	1.4988	1.4972
GSI-2426-07	1 1/2	1 21/32	7/16	1.5048	1.5008	1.6568	1.6558	1.4988	1.4972
GSI-2426-08	1 1/2	1 21/32	1/2	1.5048	1.5008	1.6568	1.6558	1.4988	1.4972
GSI-2426-12	1 1/2	1 21/32	3/4	1.5048	1.5008	1.6568	1.6558	1.4988	1.4972
GSI-2426-16	1 1/2	1 21/32	1	1.5048	1.5008	1.6568	1.6558	1.4988	1.4972

iglide® Plain Bearings G300 - Sleeve Bearing, Inch

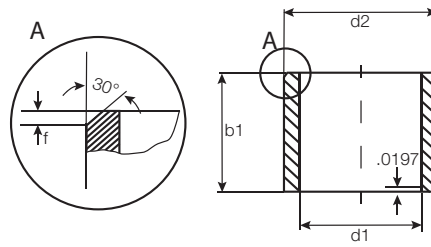

For tolerance values
please refer to page 6.4

iglide® G300
Sleeve - Inch

Part Number	d1	d2	b1	I.D. After Pressfit		Housing Bore		Shaft Size	
				Max.	Min.	Max.	Min.	Max.	Min.
GSI-2426-24	1 1/2	1 21/32	1 1/2	1.5048	1.5008	1.6568	1.6558	1.4988	1.4972
GSI-2629-14	1 5/8	1 25/32	7/8	1.6297	1.6258	1.7818	1.7808	1.6238	1.6222
GSI-2629-20	1 5/8	1 25/32	1 1/4	1.6297	1.6258	1.7818	1.7808	1.6238	1.6222
GSI-2831-16	1 3/4	1 15/16	1	1.7547	1.7508	1.9381	1.9371	1.7487	1.7471
GSI-2831-24	1 3/4	1 15/16	1 1/2	1.7547	1.7508	1.9381	1.9371	1.7487	1.7471
GSI-2831-32	1 3/4	1 15/16	2	1.7547	1.7508	1.9381	1.9371	1.7487	1.7471
GSI-2831-40	1 3/4	1 15/16	2 1/2	1.7547	1.7508	1.9381	1.9371	1.7487	1.7471
GSI-2831-48	1 3/4	1 15/16	3	1.7547	1.7508	1.9381	1.9371	1.7487	1.7471
GSI-3235-16	2	2 3/16	1	2.0059	2.0012	2.1883	2.1871	1.9981	1.9969
GSI-3235-24	2	2 3/16	1 1/2	2.0059	2.0012	2.1883	2.1871	1.9981	1.9969
GSI-3235-32	2	2 3/16	2	2.0059	2.0012	2.1883	2.1871	1.9981	1.9969
GSI-3639-32	2 1/4	2 7/16	2	2.2577	2.2531	2.4377	2.4365	2.2507	2.2489
GSI-4043-32	2 2/4	2 11/16	2	2.5082	2.5035	2.6881	2.6869	2.5000	2.4971
GSI-4447-32	2 3/4	2 15/16	2	2.7570	2.7523	2.9370	2.9358	2.7500	2.7471
GSI-4851-32	3	3 3/16	2	3.0070	3.0023	3.1872	3.1858	3.0000	2.9971

PDF: www.igus.com/iglide-pdfs
 CAD: www.igus.com/iglide-CAD
 RoHS info: www.igus.com/RoHS

Navigation icons: +, |, i, inch, mm

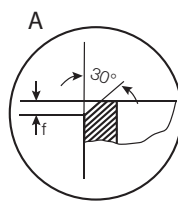

$r = \text{max. } .0197$

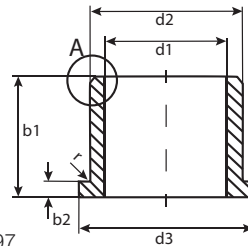

For tolerance values
please refer to page 6.4

iglide® G300
Flange - Inch

Telephone 1-800-521-2747
Fax 1-401-438-7270

Internet: <http://www.igus.com>
email: sales@igus.com
QuickSpec: <http://www.igus.com/iglide-quickspec>

Part Number	d1	d2	b1	d3	b2	I.D. After Pressfit		Housing Bore		Shaft Size	
						Max.	Min.	Max.	Min.	Max.	Min.
GFI-0203-02	1/8	3/16	1/8	.312	.032	.1269	.1251	.1878	.1873	.1243	.1236
GFI-0203-03	1/8	3/16	3/16	.312	.032	.1269	.1251	.1878	.1873	.1243	.1236
GFI-0203-04	1/8	3/16	1/4	.312	.032	.1269	.1251	.1878	.1873	.1243	.1236
GFI-0203-06	1/8	3/16	3/8	.312	.032	.1269	.1251	.1878	.1873	.1243	.1236
GFI-0304-04	3/16	1/4	1/4	.375	.032	.1892	.1873	.2503	.2497	.1865	.1858
GFI-0304-06	3/16	1/4	3/8	.375	.032	.1892	.1873	.2503	.2497	.1865	.1858
GFI-0304-08	3/16	1/4	1/2	.375	.032	.1892	.1873	.2503	.2497	.1865	.1858
GFI-0405-2.4	1/4	5/16	5/32	.500	.032	.2521	.2498	.3128	.3122	.2490	.2481
GFI-0405-04	1/4	5/16	1/4	.500	.032	.2521	.2498	.3128	.3122	.2490	.2481
GFI-0405-05	1/4	5/16	5/16	.500	.032	.2521	.2498	.3128	.3122	.2490	.2481
GFI-0405-06	1/4	5/16	3/8	.500	.032	.2521	.2498	.3128	.3122	.2490	.2481
GFI-0405-08	1/4	5/16	1/2	.500	.032	.2521	.2498	.3128	.3122	.2490	.2481
GFI-0405-12	1/4	5/16	3/4	.500	.032	.2521	.2498	.3128	.3122	.2490	.2481
GFI-0506-03	5/16	3/8	3/16	.562	.032	.3148	.3125	.3753	.3747	.3115	.3106
GFI-0506-04	5/16	3/8	1/4	.562	.032	.3148	.3125	.3753	.3747	.3115	.3106
GFI-0506-06	5/16	3/8	3/8	.562	.032	.3148	.3125	.3753	.3747	.3115	.3106
GFI-0506-08	5/16	3/8	1/2	.562	.032	.3148	.3125	.3753	.3747	.3115	.3106
GFI-0506-12	5/16	3/8	3/4	.562	.032	.3148	.3125	.3753	.3747	.3115	.3106
GFI-0607-04	3/8	15/32	1/4	.687	.046	.3773	.3750	.4691	.4684	.3740	.3731
GFI-0607-05	3/8	15/32	5/16	.687	.046	.3773	.3750	.4691	.4684	.3740	.3731
GFI-0607-06	3/8	15/32	3/8	.687	.046	.3773	.3750	.4691	.4684	.3740	.3731
GFI-0607-08	3/8	15/32	1/2	.687	.046	.3773	.3750	.4691	.4684	.3740	.3731
GFI-0607-12	3/8	15/32	3/4	.687	.046	.3773	.3750	.4691	.4684	.3740	.3731
GFI-0607-14	3/8	15/32	7/8	.687	.046	.3773	.3750	.4691	.4684	.3740	.3731
GFI-0708-04	7/16	17/32	1/4	.750	.046	.4406	.4379	.5316	.5309	.4365	.4355
GFI-0708-08	7/16	17/32	1/2	.750	.046	.4406	.4379	.5316	.5309	.4365	.4355
GFI-0809-02	1/2	19/32	1/8	.875	.046	.5030	.5003	.5941	.5934	.4990	.4980
GFI-0809-04	1/2	19/32	1/4	.875	.046	.5030	.5003	.5941	.5934	.4990	.4980
GFI-0809-05	1/2	19/32	5/16	.875	.046	.5030	.5003	.5941	.5934	.4990	.4980
GFI-0809-06	1/2	19/32	3/8	.875	.046	.5030	.5003	.5941	.5934	.4990	.4980
GFI-0809-08	1/2	19/32	1/2	.875	.046	.5030	.5003	.5941	.5934	.4990	.4980
GFI-0809-12	1/2	19/32	3/4	.875	.046	.5030	.5003	.5941	.5934	.4990	.4980
GFI-0809-16	1/2	19/32	1	.875	.046	.5030	.5003	.5941	.5934	.4990	.4980
GFI-1011-06	5/8	23/32	3/8	.937	.046	.6280	.6253	.7192	.7184	.6240	.6230
GFI-1011-08	5/8	23/32	1/2	.937	.046	.6280	.6253	.7192	.7184	.6240	.6230
GFI-1011-12	5/8	23/32	3/4	.937	.046	.6280	.6253	.7192	.7184	.6240	.6230
GFI-1011-14	5/8	23/32	7/8	.937	.046	.6280	.6253	.7192	.7184	.6240	.6230
GFI-1011-16	5/8	23/32	1	.937	.046	.6280	.6253	.7192	.7184	.6240	.6230
GFI-1011-24	5/8	23/32	1 1/2	.937	.046	.6280	.6253	.7192	.7184	.6240	.6230
GFI-1214-02	3/4	7/8	1/8	1.125	.062	.7541	.7508	.8755	.8747	.7491	.7479
GFI-1214-06	3/4	7/8	3/8	1.125	.062	.7541	.7508	.8755	.8747	.7491	.7479

iglide® Plain Bearings G300 - Flange Bearing, Inch

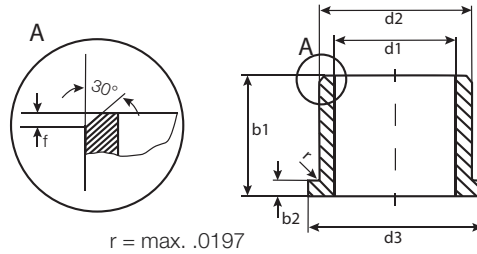

For tolerance values
please refer to page 6.4

iglide® G300
Flange - Inch

Part Number	d1	d2	b1	d3	b2 -.0055	I.D. After Pressfit		Housing Bore		Shaft Size	
						Max.	Min.	Max.	Min.	Max.	Min.
GFI-1214-08	3/4	7/8	1/2	1.125	.062	.7541	.7508	.8755	.8747	.7491	.7479
GFI-1214-10	3/4	7/8	5/8	1.125	.062	.7541	.7508	.8755	.8747	.7491	.7479
GFI-1214-12	3/4	7/8	3/4	1.125	.062	.7541	.7508	.8755	.8747	.7491	.7479
GFI-1214-16	3/4	7/8	1	1.125	.062	.7541	.7508	.8755	.8747	.7491	.7479
GFI-1214-24	3/4	7/8	1 1/2	1.125	.062	.7541	.7508	.8755	.8747	.7491	.7479
GFI-1416-08	7/8	1	1/2	1.250	.062	.8791	.8757	1.0005	.9997	.8741	.8729
GFI-1416-12	7/8	1	3/4	1.250	.062	.8791	.8757	1.0005	.9997	.8741	.8729
GFI-1416-16	7/8	1	1	1.250	.062	.8791	.8757	1.0005	.9997	.8741	.8729
GFI-1416-20	7/8	1	1 1/4	1.250	.062	.8791	.8757	1.0005	.9997	.8741	.8729
GFI-1416-24	7/8	1	1 1/2	1.250	.062	.8791	.8757	1.0005	.9997	.8741	.8729
GFI-1618-08	1	1 1/8	1/2	1.375	.062	1.0041	1.0007	1.1255	1.1247	.9991	.9979
GFI-1618-12	1	1 1/8	3/4	1.375	.062	1.0041	1.0007	1.1255	1.1247	.9991	.9979
GFI-1618-16	1	1 1/8	1	1.375	.062	1.0041	1.0007	1.1255	1.1247	.9991	.9979
GFI-1618-20	1	1 1/8	1 1/4	1.375	.062	1.0041	1.0007	1.1255	1.1247	.9991	.9979
GFI-1618-24	1	1 1/8	1 1/2	1.375	.062	1.0041	1.0007	1.1255	1.1247	.9991	.9979
GFI-1820-12	1 1/8	1 9/32	3/4	1.562	.078	1.1288	1.1254	1.2818	1.2808	1.1238	1.1226
GFI-1820-24	1 1/8	1 9/32	1 1/2	1.562	.078	1.1288	1.1254	1.2818	1.2808	1.1238	1.1226
GFI-2022-06	1 1/4	1 13/32	3/8	1.687	.078	1.2548	1.2508	1.4068	1.4058	1.2488	1.2472
GFI-2022-12	1 1/4	1 13/32	3/4	1.687	.078	1.2548	1.2508	1.4068	1.4058	1.2488	1.2472
GFI-2022-14	1 1/4	1 13/32	7/8	1.687	.078	1.2548	1.2508	1.4068	1.4058	1.2488	1.2472
GFI-2022-16	1 1/4	1 13/32	1	1.687	.078	1.2548	1.2508	1.4068	1.4058	1.2488	1.2472
GFI-2022-20	1 1/4	1 13/32	1 1/4	1.687	.078	1.2548	1.2508	1.4068	1.4058	1.2488	1.2472
GFI-2022-24	1 1/4	1 13/32	1 1/2	1.687	.078	1.2548	1.2508	1.4068	1.4058	1.2488	1.2472
GFI-2224-16	1 3/8	1 17/32	1	1.875	.078	1.3798	1.3758	1.5318	1.5308	1.3738	1.3722
GFI-2426-12	1 1/2	1 21/32	3/4	2.000	.078	1.5048	1.5008	1.6568	1.6558	1.4988	1.4972
GFI-2426-16	1 1/2	1 21/32	1	2.000	.078	1.5048	1.5008	1.6568	1.6558	1.4988	1.4972
GFI-2426-24	1 1/2	1 21/32	1 1/2	2.000	.078	1.5048	1.5008	1.6568	1.6558	1.4988	1.4972
GFI-2831-16	1 3/4	1 15/16	1	2.375	.093	1.7547	1.7508	1.9381	1.9371	1.7487	1.7471
GFI-2831-24	1 3/4	1 15/16	1 1/2	2.375	.093	1.7547	1.7508	1.9381	1.9371	1.7487	1.7471
GFI-2831-32	1 3/4	1 15/16	2	2.375	.093	1.7547	1.7508	1.9381	1.9371	1.7487	1.7471
GFI-3235-16	2	2 3/16	1	2.625	.093	2.0059	2.0012	2.1883	2.1871	1.9981	1.9969
GFI-3235-24	2	2 3/16	1 1/2	2.625	.093	2.0059	2.0012	2.1883	2.1871	1.9981	1.9969
GFI-3235-32	2	2 3/16	2	2.625	.093	2.0059	2.0012	2.1883	2.1871	1.9981	1.9969
GFI-3639-32	2 1/4	2 7/16	2	2.750	.093	2.2577	2.2531	2.4377	2.4365	2.2507	2.2489
GFI-4043-32	2 1/2	2 11/16	2	3.125	.093	2.5082	2.5035	2.6881	2.6869	2.5000	2.4971
GFI-4447-32	2 3/4	2 15/16	2	3.375	.093	2.7570	2.7523	2.9370	2.9358	2.7500	2.7471

PDF: www.igus.com/iglide-pdfs
CAD: www.igus.com/iglide-CAD
RoHS info: www.igus.com/RoHS

+

|

i

inch

mm



iglide® Plain Bearings
G300 - Thrust Washer, Inch

iglide® G300
Thrust Washer - Inch

Telephone 1-800-521-2747
Fax 1-401-438-7270

Internet: <http://www.igus.com>
email: sales@igus.com
QuickSpec: <http://www.igus.com/iglide-quickspec>

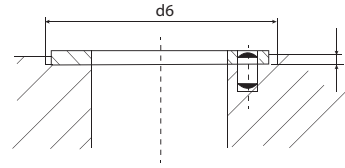
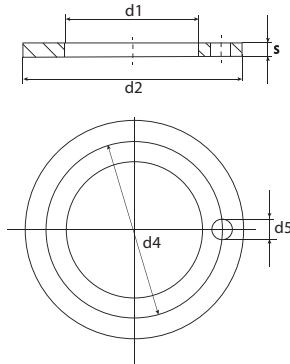

Part Number	d1 +.010	d2 -.010	s -.0020	d4 +-.005	d5 +.015 +.005	h +.008	d6 +.005
GTI-0610-01	.375	.625	.040	*	*	*	.375
GTI-0814-01	.500	.875	.0585	.692	.067	.040	.875
GTI-1018-01	.625	1.125	.0585	.880	.099	.040	1.125
GTI-1220-01	.750	1.250	.0585	1.005	.099	.040	1.250
GTI-1424-01	.875	1.500	.0585	1.192	.130	.040	1.500
GTI-1628-01	1.000	1.750	.0585	1.380	.130	.040	1.750
GTI-2034-01	1.250	2.125	.0585	1.692	.161	.040	2.125
GTI-2440-01	1.500	2.500	.0585	2.005	.192	.040	2.500
GTI-2844-01	1.750	2.750	.0585	2.255	.192	.040	2.750
GTI-3248-01	2.000	3.000	.0895	2.505	.192	.070	3.000

*Designed without fixation hole

iglide® Plain Bearings G300 - Sleeve Bearing, MM



G300

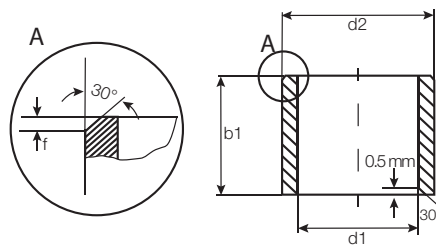

For tolerance values
please refer to page 6.4

Dimensions according to ISO 3547-1 and special dimensions

Part Number	d1		d2	b1 h13	I.D. After Pressfit		Housing Bore		Shaft Size	
	after pressfit in Ø H7				Max.	Min.	Max.	Min.	Max.	Min.
GSM-0103-02	1.5	+0.014 +0.054	3.0	2.0	1.554	1.514	3.010	3.000	1.500	1.475
GSM-0203-03	2.0	+0.014 +0.054	3.5	3.0	2.054	2.014	3.510	3.500	2.000	1.975
GSM-02504-05	2.5	+0.014 +0.054	4.5	5.0	2.554	2.514	4.510	4.500	2.500	2.475
GSM-0304-03	3.0	+0.014 +0.054	4.5	3.0	3.054	3.014	4.512	4.500	3.000	2.975
GSM-0304-05	3.0	+0.014 +0.054	4.5	5.0	3.054	3.014	4.512	4.500	3.000	2.975
GSM-0304-06	3.0	+0.014 +0.054	4.5	6.0	3.054	3.014	4.512	4.500	3.000	2.975
GSM-0304-16	3.0	+0.014 +0.054	4.5	16.0	3.054	3.014	4.512	4.500	3.000	2.975
GSM-0405-04	4.0	+0.020 +0.068	5.5	4.0	4.068	4.020	5.512	5.500	4.000	3.970
GSM-0405-06	4.0	+0.020 +0.068	5.5	6.0	4.068	4.020	5.512	5.500	4.000	3.970
GSM-0406-08	4.5	+0.020 +0.068	6.0	8.0	4.568	4.520	6.012	6.000	4.500	4.470
GSM-0407-05	4.0	+0.020 +0.068	7.0	5.0	4.068	4.020	7.015	7.000	4.000	3.970
GSM-0407-055	4.0	+0.020 +0.068	7.0	5.5	4.068	4.020	7.015	7.000	4.000	3.970
GSM-0506-046	5.0	+0.010 +0.040	6.0	4.6	5.040	5.010	6.012	6.000	5.000	4.970
GSM-0506-05	5.0	+0.010 +0.040	6.0	5.0	5.040	5.010	6.012	6.000	5.000	4.970
GSM-0506-07	5.0	+0.010 +0.040	6.0	7.0	5.040	5.010	6.012	6.000	5.000	4.970
GSM-0507-05	5.0	+0.020 +0.068	7.0	5.0	5.068	5.020	7.015	7.000	5.000	4.970
GSM-0507-08	5.0	+0.020 +0.068	7.0	8.0	5.068	5.020	7.015	7.000	5.000	4.970
GSM-0507-10	5.0	+0.020 +0.068	7.0	10.0	5.068	5.020	7.015	7.000	5.000	4.970
GSM-0607-06	6.0	+0.010 +0.040	7.0	6.0	6.040	6.010	7.015	7.000	6.000	5.970
GSM-0607-12	6.0	+0.010 +0.040	7.0	12.0	6.040	6.010	7.015	7.000	6.000	5.970
GSM-0607-17.5	6.0	+0.010 +0.040	7.0	17.5	6.040	6.010	7.015	7.000	6.000	5.970
GSM-0608-025	6.0	+0.020 +0.068	8.0	2.5	6.068	6.020	8.015	8.000	6.000	5.970
GSM-0608-04	6.0	+0.020 +0.068	8.0	4.0	6.068	6.020	8.015	8.000	6.000	5.970
GSM-0608-05	6.0	+0.020 +0.068	8.0	5.0	6.068	6.020	8.015	8.000	6.000	5.970
GSM-0608-055	6.0	+0.020 +0.068	8.0	5.5	6.068	6.020	8.015	8.000	6.000	5.970
GSM-0608-06	6.0	+0.020 +0.068	8.0	6.0	6.068	6.020	8.015	8.000	6.000	5.970
GSM-0608-08	6.0	+0.020 +0.068	8.0	8.0	6.068	6.020	8.015	8.000	6.000	5.970
GSM-0608-09	6.0	+0.020 +0.068	8.0	9.5	6.068	6.020	8.015	8.000	6.000	5.970
GSM-0608-10	6.0	+0.020 +0.068	8.0	10.0	6.068	6.020	8.015	8.000	6.000	5.970
GSM-0608-11	6.0	+0.020 +0.068	8.0	11.8	6.068	6.020	8.015	8.000	6.000	5.970
GSM-0608-13	6.0	+0.020 +0.068	8.0	13.8	6.068	6.020	8.015	8.000	6.000	5.970
GSM-0708-10	7.0	+0.013 +0.049	8.0	10.0	7.049	7.013	8.015	8.000	7.000	6.964
GSM-0708-19	7.0	+0.013 +0.049	8.0	19.0	7.049	7.013	8.015	8.000	7.000	6.964
GSM-0709-05	7.0	+0.025 +0.083	9.0	5.0	7.083	7.025	9.015	9.000	7.000	6.964
GSM-0709-08	7.0	+0.025 +0.083	9.0	8.0	7.083	7.025	9.015	9.000	7.000	6.964
GSM-0709-09	7.0	+0.025 +0.083	9.0	9.0	7.083	7.025	9.015	9.000	7.000	6.964
GSM-0709-10	7.0	+0.025 +0.083	9.0	10.0	7.083	7.025	9.015	9.000	7.000	6.694
GSM-0709-12	7.0	+0.025 +0.083	9.0	12.0	7.083	7.025	9.015	9.000	7.000	6.694
GSM-0809-05	8.0	+0.013 +0.049	9.0	5.0	8.049	8.013	9.015	9.000	8.000	7.964
GSM-0809-06	8.0	+0.013 +0.049	9.0	6.0	8.049	8.013	9.015	9.000	8.000	7.964
GSM-0809-08	8.0	+0.013 +0.049	9.0	8.0	8.049	8.013	9.015	9.000	8.000	7.964

iglide® G300
Sleeve - MM

PDF: www.igus.com/iglide-pdfs
CAD: www.igus.com/iglide-CAD
RoHS info: www.igus.com/RoHS

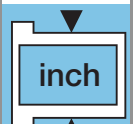

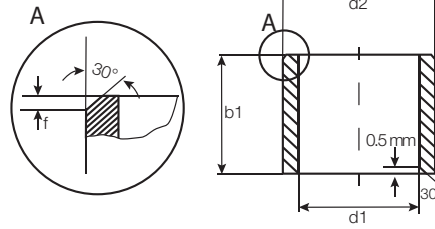

For tolerance values
please refer to page 6.4

Dimensions according to ISO 3547-1 and special dimensions

Part Number	d1	d1-Tolerance after pressfit in Ø H7	d2	b1 h13	I.D. After Pressfit		Housing Bore		Shaft Size	
					Max.	Min.	Max.	Min.	Max.	Min.
GSM-0809-12	8.0	+0.013 +0.049	9.0	12.0	8.049	8.013	9.015	9.000	8.000	7.964
GSM-0810-05	8.0	+0.025 +0.083	10.0	5.0	8.083	8.025	10.015	10.000	8.000	7.964
GSM-0810-06	8.0	+0.025 +0.083	10.0	6.0	8.083	8.025	10.015	10.000	8.000	7.964
GSM-0810-07	8.0	+0.025 +0.083	10.0	7.0	8.083	8.025	10.015	10.000	8.000	7.964
GSM-0810-08	8.0	+0.025 +0.083	10.0	8.0	8.083	8.025	10.015	10.000	8.000	7.964
GSM-0810-10	8.0	+0.025 +0.083	10.0	10.0	8.083	8.025	10.015	10.000	8.000	7.964
GSM-0810-12	8.0	+0.025 +0.083	10.0	12.0	8.083	8.025	10.015	10.000	8.000	7.964
GSM-0810-13	8.0	+0.025 +0.083	10.0	13.0	8.083	8.025	10.015	10.000	8.000	7.964
GSM-0810-15	8.0	+0.025 +0.083	10.0	15.0	8.083	8.025	10.015	10.000	8.000	7.964
GSM-0810-16	8.0	+0.025 +0.083	10.0	16.0	8.083	8.025	10.015	10.000	8.000	7.964
GSM-0810-20	8.0	+0.025 +0.083	10.0	20.0	8.083	8.025	10.015	10.000	8.000	7.964
GSM-0810-22	8.0	+0.025 +0.083	10.0	22.0	8.083	8.025	10.015	10.000	8.000	7.964
GSM-0911-06	9.0	+0.025 +0.083	11.0	6.0	9.083	9.025	11.018	11.000	9.000	8.964
GSM-1011-06	10.0	+0.013 +0.049	11.0	6.0	10.049	10.013	11.018	11.000	10.000	9.964
GSM-1011-10	10.0	+0.013 +0.049	11.0	10.0	10.049	10.013	11.018	11.000	10.000	9.964
GSM-1011-20	10.0	+0.013 +0.049	11.0	20.0	10.049	10.013	11.018	11.000	10.000	9.964
GSM-1011-25	10.0	+0.013 +0.049	11.0	25.0	10.049	10.013	11.018	11.000	10.000	9.964
GSM-1011-30	10.0	+0.013 +0.049	11.0	30.0	10.049	10.013	11.018	11.000	10.000	9.964
GSM-1012-04	10.0	+0.025 +0.083	12.0	4.0	10.083	10.025	12.018	12.000	10.000	9.964
GSM-1012-045	10.0	+0.025 +0.083	12.0	4.5	10.083	10.025	12.018	12.000	10.000	9.964
GSM-1012-05	10.0	+0.025 +0.083	12.0	5.0	10.083	10.025	12.018	12.000	10.000	9.964
GSM-1012-06	10.0	+0.025 +0.083	12.0	6.0	10.083	10.025	12.018	12.000	10.000	9.964
GSM-1012-07	10.0	+0.025 +0.083	12.0	7.0	10.083	10.025	12.018	12.000	10.000	9.964
GSM-1012-08	10.0	+0.025 +0.083	12.0	8.0	10.083	10.025	12.018	12.000	10.000	9.964
GSM-1012-09	10.0	+0.025 +0.083	12.0	9.0	10.083	10.025	12.018	12.000	10.000	9.964
GSM-1012-10	10.0	+0.025 +0.083	12.0	10.0	10.083	10.025	12.018	12.000	10.000	9.964
GSM-1012-12	10.0	+0.025 +0.083	12.0	12.0	10.083	10.025	12.018	12.000	10.000	9.964
GSM-1012-14	10.0	+0.025 +0.083	12.0	14.0	10.083	10.025	12.018	12.000	10.000	9.964
GSM-1012-15	10.0	+0.025 +0.083	12.0	15.0	10.083	10.025	12.018	12.000	10.000	9.964
GSM-1012-17	10.0	+0.025 +0.083	12.0	17.0	10.083	10.025	12.018	12.000	10.000	9.964
GSM-1012-20	10.0	+0.025 +0.083	12.0	20.0	10.083	10.025	12.018	12.000	10.000	9.964
GSM-1013-13	10.0	+0.025 +0.083	13.0	13.5	10.083	10.025	13.018	13.000	10.000	9.964
GSM-1014-10	10.0	+0.025 +0.083	14.0	10.0	10.083	10.025	14.018	14.000	10.000	9.964
GSM-1014-20	10.0	+0.025 +0.083	14.0	20.0	10.083	10.025	14.018	14.000	10.000	9.964
GSM-1213-047	12.0	+0.016 +0.059	13.0	4.7	12.059	12.016	13.018	13.000	12.000	11.957
GSM-1213-10	12.0	+0.016 +0.059	13.0	10.0	12.059	12.016	13.018	13.000	12.000	11.957
GSM-1213-12	12.0	+0.016 +0.059	13.0	12.0	12.059	12.016	13.018	13.000	12.000	11.957
GSM-1213-15	12.0	+0.016 +0.059	13.0	15.0	12.059	12.016	13.018	13.000	12.000	11.957
GSM-1214-04	12.0	+0.032 +0.102	14.0	4.0	12.102	12.032	14.018	14.000	12.000	11.957
GSM-1214-05	12.0	+0.032 +0.102	14.0	5.0	12.102	12.032	14.018	14.000	12.000	11.957

iglide® Plain Bearings

G300 - Sleeve Bearing, MM



G300

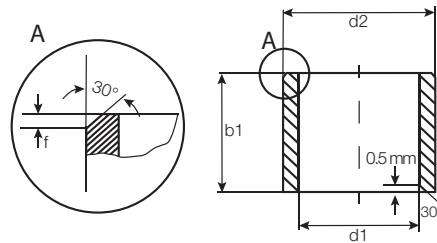

For tolerance values
please refer to page 6.4

Dimensions according to ISO 3547-1 and special dimensions

Part Number	d1		d2	b1 h13	I.D. After Pressfit		Housing Bore		Shaft Size	
	after pressfit in Ø H7				Max.	Min.	Max.	Min.	Max.	Min.
GSM-1214-06	12.0	+0.032 +0.102	14.0	6.0	12.102	12.032	14.018	14.000	12.000	11.957
GSM-1214-08	12.0	+0.032 +0.102	14.0	8.0	12.102	12.032	14.018	14.000	12.000	11.957
GSM-1214-10	12.0	+0.032 +0.102	14.0	10.0	12.102	12.032	14.018	14.000	12.000	11.957
GSM-1214-12	12.0	+0.032 +0.102	14.0	12.0	12.102	12.032	14.018	14.000	12.000	11.957
GSM-1214-14	12.0	+0.032 +0.102	14.0	14.0	12.102	12.032	14.018	14.000	12.000	11.957
GSM-1214-15	12.0	+0.032 +0.102	14.0	15.0	12.102	12.032	14.018	14.000	12.000	11.957
GSM-1214-20	12.0	+0.032 +0.102	14.0	20.0	12.102	12.032	14.018	14.000	12.000	11.957
GSM-1214-25	12.0	+0.032 +0.102	14.0	25.0	12.102	12.032	14.018	14.000	12.000	11.957
GSM-1215-06	12.0	+0.032 +0.102	15.0	6.0	12.102	12.032	15.018	15.000	12.000	11.957
GSM-1215-22	12.0	+0.032 +0.102	15.0	22.0	12.102	12.032	15.018	15.000	12.000	11.957
GSM-1315-07	13.0	+0.032 +0.102	15.0	7.0	13.102	13.032	15.018	15.000	13.000	12.957
GSM-1315-075	13.0	+0.032 +0.102	15.0	7.5	13.102	13.032	15.018	15.000	13.000	12.957
GSM-1315-10	13.0	+0.032 +0.102	15.0	10.0	13.102	13.032	15.018	15.000	13.000	12.957
GSM-1315-15	13.0	+0.032 +0.102	15.0	15.0	13.102	13.032	15.018	15.000	13.000	12.957
GSM-1315-20	13.0	+0.032 +0.102	15.0	20.0	13.102	13.032	15.018	15.000	13.000	12.957
GSM-1315-25	13.0	+0.032 +0.102	15.0	25.0	13.102	13.032	15.018	15.000	13.000	12.957
GSM-1416-03	14.0	+0.032 +0.102	16.0	3.0	14.102	14.032	16.018	16.000	14.000	13.957
GSM-1416-06	14.0	+0.032 +0.102	16.0	6.0	14.102	14.032	16.018	16.000	14.000	13.957
GSM-1416-08	14.0	+0.032 +0.102	16.0	8.0	14.102	14.032	16.018	16.000	14.000	13.957
GSM-1416-10	14.0	+0.032 +0.102	16.0	10.0	14.102	14.032	16.018	16.000	14.000	13.957
GSM-1416-12	14.0	+0.032 +0.102	16.0	12.0	14.102	14.032	16.018	16.000	14.000	13.957
GSM-1416-15	14.0	+0.032 +0.102	16.0	15.0	14.102	14.032	16.018	16.000	14.000	13.957
GSM-1416-20	14.0	+0.032 +0.102	16.0	20.0	14.102	14.032	16.018	16.000	14.000	13.957
GSM-1416-25	14.0	+0.032 +0.102	16.0	25.0	14.102	14.032	16.018	16.000	14.000	13.957
GSM-1516-15	15.0	+0.016 +0.059	16.0	15.0	15.059	15.016	16.018	16.000	15.000	14.957
GSM-1517-04	15.0	+0.032 +0.102	17.0	4.0	15.102	15.032	17.018	17.000	15.000	14.957
GSM-1517-10	15.0	+0.032 +0.102	17.0	10.0	15.102	15.032	17.018	17.000	15.000	14.957
GSM-1517-12	15.0	+0.032 +0.102	17.0	12.0	15.102	15.032	17.018	17.000	15.000	14.957
GSM-1517-15	15.0	+0.032 +0.102	17.0	15.0	15.102	15.032	17.018	17.000	15.000	14.957
GSM-1517-20	15.0	+0.032 +0.102	17.0	20.0	15.102	15.032	17.018	17.000	15.000	14.957
GSM-1517-25	15.0	+0.032 +0.102	17.0	25.0	15.102	15.032	17.018	17.000	15.000	14.957
GSM-1618-055	16.0	+0.032 +0.102	18.0	5.5	16.102	16.032	18.018	18.000	16.000	15.957
GSM-1618-08	16.0	+0.032 +0.102	18.0	8.0	16.102	16.032	18.018	18.000	16.000	15.957
GSM-1618-10	16.0	+0.032 +0.102	18.0	10.0	16.102	16.032	18.018	18.000	16.000	15.957
GSM-1618-12	16.0	+0.032 +0.102	18.0	12.0	16.102	16.032	18.018	18.000	16.000	15.957
GSM-1618-13.5	16.0	+0.032 +0.102	18.0	13.5	16.102	16.032	18.018	18.000	16.000	15.957
GSM-1618-13.8	16.0	+0.032 +0.102	18.0	13.8	16.102	16.032	18.018	18.000	16.000	15.957
GSM-1618-15	16.0	+0.032 +0.102	18.0	15.0	16.102	16.032	18.018	18.000	16.000	15.957
GSM-1618-20	16.0	+0.032 +0.102	18.0	20.0	16.102	16.032	18.018	18.000	16.000	15.957
GSM-1618-25	16.0	+0.032 +0.102	18.0	25.0	16.102	16.032	18.018	18.000	16.000	15.957

iglide® G300
Sleeve - MM

PDF: www.igus.com/iglide-pdfs
CAD: www.igus.com/iglide-CAD
RoHS info: www.igus.com/RoHS

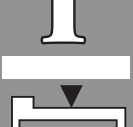
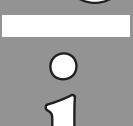

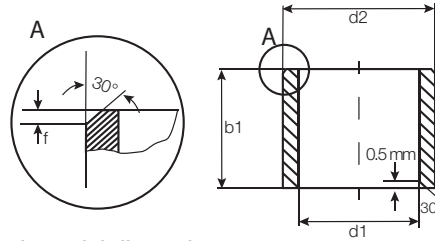

For tolerance values
please refer to page 6.4

Dimensions according to ISO 3547-1 and special dimensions

Part Number	d1	d1-Tolerance after pressfit in \varnothing H7	d2	b1 h13	I.D. After Pressfit		Housing Bore		Shaft Size	
					Max.	Min.	Max.	Min.	Max.	Min.
GSM-1618-30	16.0	+0.032 +0.102	18.0	30.0	16.102	16.032	18.018	18.000	16.000	15.957
GSM-1618-50	16.0	+0.032 +0.102	18.0	50.0	16.102	16.032	18.018	18.000	16.000	15.957
GSM-1819-15	18.0	+0.032 +0.102	19.0	15.0	18.102	18.032	19.021	19.000	18.000	17.957
GSM-1820-10	18.0	+0.032 +0.102	20.0	10.0	18.102	18.032	20.021	20.000	18.000	17.957
GSM-1820-12	18.0	+0.032 +0.102	20.0	12.0	18.102	18.032	20.021	20.000	18.000	17.957
GSM-1820-15	18.0	+0.032 +0.102	20.0	15.0	18.102	18.032	20.021	20.000	18.000	17.957
GSM-1820-20	18.0	+0.032 +0.102	20.0	20.0	18.102	18.032	20.021	20.000	18.000	17.957
GSM-1820-25	18.0	+0.032 +0.102	20.0	25.0	18.102	18.032	20.021	20.000	18.000	17.957
GSM-1820-34	18.0	+0.032 +0.102	20.0	34.0	18.102	18.032	20.021	20.000	18.000	17.957
GSM-1820-45	18.0	+0.032 +0.102	20.0	45.0	18.102	18.032	20.021	20.000	18.000	17.957
GSM-1922-06	19.0	+0.040 +0.124	22.0	6.0	19.124	19.040	22.021	22.000	19.000	18.948
GSM-1922-28	19.0	+0.040 +0.124	22.0	28.0	19.124	19.040	22.021	22.000	19.000	18.948
GSM-1922-35	19.0	+0.040 +0.124	22.0	35.0	19.124	19.040	22.021	22.000	19.000	18.948
GSM-2021-20	20.0	+0.020 +0.072	21.0	20.0	20.072	20.020	21.021	21.000	20.000	19.948
GSM-2022-03	20.0	+0.040 +0.124	22.0	3.0	20.124	20.040	22.021	22.000	20.000	19.948
GSM-2022-08	20.0	+0.040 +0.124	22.0	8.0	20.124	20.040	22.021	22.000	20.000	19.948
GSM-2022-105	20.0	+0.040 +0.124	22.0	10.5	20.124	20.040	22.021	22.000	20.000	19.948
GSM-2022-15	20.0	+0.040 +0.124	22.0	15.0	20.124	20.040	22.021	22.000	20.000	19.948
GSM-2022-20	20.0	+0.040 +0.124	22.0	20.0	20.124	20.040	22.021	22.000	20.000	19.948
GSM-2022-22	20.0	+0.040 +0.124	22.0	22.0	20.124	20.040	22.021	22.000	20.000	19.948
GSM-2022-30	20.0	+0.040 +0.124	22.0	30.0	20.124	20.040	22.021	22.000	20.000	19.948
GSM-2022-47	20.0	+0.040 +0.124	22.0	47.0	20.124	20.040	22.021	22.000	20.000	19.948
GSM-2023-10	20.0	+0.040 +0.124	23.0	10.0	20.124	20.040	23.021	23.000	20.000	19.948
GSM-2023-15	20.0	+0.040 +0.124	23.0	15.0	20.124	20.040	23.021	23.000	20.000	19.948
GSM-2023-20	20.0	+0.040 +0.124	23.0	20.0	20.124	20.040	23.021	23.000	20.000	19.948
GSM-2023-23	20.0	+0.040 +0.124	23.0	23.0	20.124	20.040	23.021	23.000	20.000	19.948
GSM-2023-24	20.0	+0.040 +0.124	23.0	24.0	20.124	20.040	23.021	23.000	20.000	19.948
GSM-2023-25	20.0	+0.040 +0.124	23.0	25.0	20.124	20.040	23.021	23.000	20.000	19.948
GSM-2023-30	20.0	+0.040 +0.124	23.0	30.0	20.124	20.040	23.021	23.000	20.000	19.948
GSM-2224-10	22.0	+0.040 +0.124	24.0	10.0	22.124	22.040	24.021	24.000	22.000	21.948
GSM-2224-15	22.0	+0.040 +0.124	24.0	15.0	22.124	22.040	24.021	24.000	22.000	21.948
GSM-2224-17	22.0	+0.040 +0.124	24.0	17.0	22.124	22.040	24.021	24.000	22.000	21.948
GSM-2224-20	22.0	+0.040 +0.124	24.0	20.0	22.124	22.040	24.021	24.000	22.000	21.948
GSM-2224-30	22.0	+0.040 +0.124	24.0	30.0	22.124	22.040	24.021	24.000	22.000	21.948
GSM-2225-15	22.0	+0.040 +0.124	25.0	15.0	22.124	22.040	25.021	25.000	22.000	21.948
GSM-2225-20	22.0	+0.040 +0.124	25.0	20.0	22.124	22.040	25.021	25.000	22.000	21.948
GSM-2225-25	22.0	+0.040 +0.124	25.0	25.0	22.124	22.040	25.021	25.000	22.000	21.948
GSM-2225-30	22.0	+0.040 +0.124	25.0	30.0	22.124	22.040	25.021	25.000	22.000	21.948
GSM-2427-06	24.0	+0.040 +0.124	27.0	6.0	24.124	24.040	27.021	27.000	24.000	23.948
GSM-2427-15	24.0	+0.040 +0.124	27.0	15.0	24.124	24.040	27.021	27.000	24.000	23.948

iglide® G300
Sleeve - MM

Telephone 1-800-521-2747
Fax 1-401-438-7270

Internet: <http://www.igus.com>
email: sales@igus.com
QuickSpec: <http://www.igus.com/iglide-quickspec>

iglide® Plain Bearings G300 - Sleeve Bearing, MM

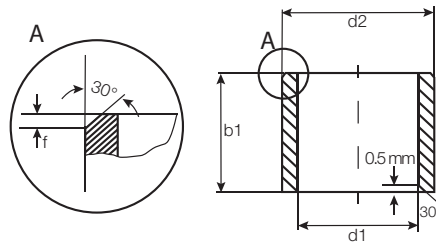

For tolerance values
please refer to page 6.4

Dimensions according to ISO 3547-1 and special dimensions

Part Number	d1		d2	b1 h13	I.D. After Pressfit		Housing Bore		Shaft Size	
	after pressfit in Ø H7				Max.	Min.	Max.	Min.	Max.	Min.
GSM-2427-20	24.0	+0.040 +0.124	27.0	20.0	24.124	24.040	27.021	27.000	24.000	23.948
GSM-2427-25	24.0	+0.040 +0.124	27.0	25.0	24.124	24.040	27.021	27.000	24.000	23.948
GSM-2427-30	24.0	+0.040 +0.124	27.0	30.0	24.124	24.040	27.021	27.000	24.000	23.948
GSM-2526-25	25.0	+0.020 +0.072	26.0	25.0	25.072	25.020	26.021	26.000	25.000	24.948
GSM-2528-12	25.0	+0.040 +0.124	28.0	12.0	25.124	25.040	28.021	28.000	25.000	24.948
GSM-2528-15	25.0	+0.040 +0.124	28.0	15.0	25.124	25.040	28.021	28.000	25.000	24.948
GSM-2528-20	25.0	+0.040 +0.124	28.0	20.0	25.124	25.040	28.021	28.000	25.000	24.948
GSM-2528-24	25.0	+0.040 +0.124	28.0	24.0	25.124	25.040	28.021	28.000	25.000	24.948
GSM-2528-25	25.0	+0.040 +0.124	28.0	25.0	25.124	25.040	28.021	28.000	25.000	24.948
GSM-2528-30	25.0	+0.040 +0.124	28.0	30.0	25.124	25.040	28.021	28.000	25.000	24.948
GSM-2528-35	25.0	+0.040 +0.124	28.0	35.0	25.124	25.040	28.021	28.000	25.000	24.948
GSM-2528-50	25.0	+0.040 +0.124	28.0	50.0	25.124	25.040	28.021	28.000	25.000	24.948
GSM-2630-16	26.0	+0.040 +0.124	30.0	16.0	26.124	26.040	30.021	30.000	26.000	25.948
GSM-2730-05	27.0	+0.040 +0.124	30.0	5.0	27.124	26.040	30.021	30.000	27.000	26.948
GSM-2832-10.5	28.0	+0.040 +0.124	32.0	10.5	28.124	28.040	32.025	32.000	28.000	27.948
GSM-2832-12	28.0	+0.040 +0.124	32.0	12.0	28.124	28.040	32.025	32.000	28.000	27.948
GSM-2832-15	28.0	+0.040 +0.124	32.0	15.0	28.124	28.040	32.025	32.000	28.000	27.948
GSM-2832-20	28.0	+0.040 +0.124	32.0	20.0	28.124	28.040	32.025	32.000	28.000	27.948
GSM-2832-23	28.0	+0.040 +0.124	32.0	23.0	28.124	28.040	32.025	32.000	28.000	27.948
GSM-2832-25	28.0	+0.040 +0.124	32.0	25.0	28.124	28.040	32.025	32.000	28.000	27.948
GSM-2832-30	28.0	+0.040 +0.124	32.0	30.0	28.124	28.040	32.025	32.000	28.000	27.948
GSM-3031-12	30.0	+0.020 +0.072	31.0	12.0	30.072	30.020	31.025	31.000	30.000	29.948
GSM-3031-30	30.0	+0.020 +0.072	31.0	30.0	30.072	30.020	31.025	31.000	30.000	29.948
GSM-3034-15	30.0	+0.040 +0.124	34.0	15.0	30.124	30.040	34.025	34.000	30.000	29.948
GSM-3034-20	30.0	+0.040 +0.124	34.0	20.0	30.124	30.040	34.025	34.000	30.000	29.948
GSM-3034-24	30.0	+0.040 +0.124	34.0	24.0	30.124	30.040	34.025	34.000	30.000	29.948
GSM-3034-25	30.0	+0.040 +0.124	34.0	25.0	30.124	30.040	34.025	34.000	30.000	29.948
GSM-3034-30	30.0	+0.040 +0.124	34.0	30.0	30.124	30.040	34.025	34.000	30.000	29.948
GSM-3034-35	30.0	+0.040 +0.124	34.0	35.0	30.124	30.040	34.025	34.000	30.000	29.948
GSM-3034-40	30.0	+0.040 +0.124	34.0	40.0	30.124	30.040	34.025	34.000	30.000	29.948
GSM-3236-20	32.0	+0.050 +0.150	36.0	20.0	32.150	32.050	36.025	36.000	32.000	31.938
GSM-3236-30	32.0	+0.050 +0.150	36.0	30.0	32.150	32.050	36.025	36.000	32.000	31.938
GSM-3236-40	32.0	+0.050 +0.150	36.0	40.0	32.150	32.050	36.025	36.000	32.000	31.938
GSM-3539-14	35.0	+0.050 +0.150	39.0	14.0	35.150	35.050	39.025	39.000	35.000	34.938
GSM-3539-20	35.0	+0.050 +0.150	39.0	20.0	35.150	35.050	39.025	39.000	35.000	34.938
GSM-3539-25	35.0	+0.050 +0.150	39.0	25.0	35.150	35.050	39.025	39.000	35.000	34.938
GSM-3539-30	35.0	+0.050 +0.150	39.0	30.0	35.150	35.050	39.025	39.000	35.000	34.938
GSM-3539-40	35.0	+0.050 +0.150	39.0	40.0	35.150	35.050	39.025	39.000	35.000	34.938
GSM-3539-50	35.0	+0.050 +0.150	39.0	50.0	35.150	35.050	39.025	39.000	35.000	34.938

iglide® G300
Sleeve - MM

PDF: www.igus.com/iglide-pdfs
CAD: www.igus.com/iglide-CAD
RoHS info: www.igus.com/RoHS



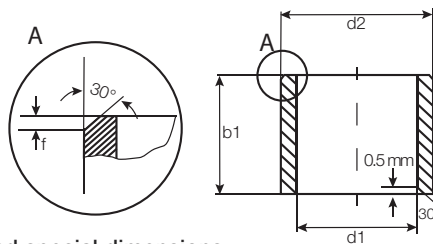

For tolerance values
please refer to page 6.4

Dimensions according to ISO 3547-1 and special dimensions

Part Number	d1	d1-Tolerance after pressfit in \varnothing H7	d2	b1 h13	I.D. After Pressfit		Housing Bore		Shaft Size	
					Max.	Min.	Max.	Min.	Max.	Min.
GSM-3640-20	36.0	+0.050 +0.150	40.0	20.0	36.150	36.050	40.025	40.000	36.000	35.938
GSM-3741-20	37.0	+0.050 +0.150	41.0	20.0	37.150	37.050	41.025	41.000	37.000	36.938
GSM-4044-10	40.0	+0.050 +0.150	44.0	10.0	40.150	40.050	44.025	44.000	40.000	39.938
GSM-4044-16	40.0	+0.050 +0.150	44.0	16.0	40.150	40.050	44.025	44.000	40.000	39.938
GSM-4044-20	40.0	+0.050 +0.150	44.0	20.0	40.150	40.050	44.025	44.000	40.000	39.938
GSM-4044-30	40.0	+0.050 +0.150	44.0	30.0	40.150	40.050	44.025	44.000	40.000	39.938
GSM-4044-40	40.0	+0.050 +0.150	44.0	40.0	40.150	40.050	44.025	44.000	40.000	39.938
GSM-4044-50	40.0	+0.050 +0.150	44.0	50.0	40.150	40.050	44.025	44.000	40.000	39.938
GSM-4246-40	42.0	+0.050 +0.150	46.0	40.0	42.150	42.050	46.025	46.000	42.000	41.938
GSM-4550-22	45.0	+0.050 +0.150	50.0	22.0	45.150	45.050	50.025	50.000	45.000	44.938
GSM-4550-30	45.0	+0.050 +0.150	50.0	30.0	45.150	45.050	50.025	50.000	45.000	44.938
GSM-4550-38	45.0	+0.050 +0.150	50.0	38.0	45.150	45.050	50.025	50.000	45.000	44.938
GSM-4550-40	45.0	+0.050 +0.150	50.0	40.0	45.150	45.050	50.025	50.000	45.000	44.938
GSM-4550-50	45.0	+0.050 +0.150	50.0	50.0	45.150	45.050	50.025	50.000	45.000	44.938
GSM-5053-50	50.0	+0.050 +0.150	53.0	50.0	50.150	50.050	53.030	53.000	50.000	49.938
GSM-5055-20	50.0	+0.050 +0.150	55.0	20.0	50.150	50.050	55.030	55.000	50.000	49.938
GSM-5055-25	50.0	+0.050 +0.150	55.0	25.0	50.150	50.050	55.030	55.000	50.000	49.938
GSM-5055-30	50.0	+0.050 +0.150	55.0	30.0	50.150	50.050	55.030	55.000	50.000	49.938
GSM-5055-40	50.0	+0.050 +0.150	55.0	40.0	50.150	50.050	55.030	55.000	50.000	49.938
GSM-5055-50	50.0	+0.050 +0.150	55.0	50.0	50.150	50.050	55.030	55.000	50.000	49.938
GSM-5257-20	52.0	+0.060 +0.180	57.0	20.0	52.180	52.060	57.030	57.000	52.000	51.926
GSM-5560-40	55.0	+0.060 +0.180	60.0	40.0	55.180	55.060	60.030	60.000	55.000	54.926
GSM-5560-50	55.0	+0.060 +0.180	60.0	50.0	55.180	55.060	60.030	60.000	55.000	54.926
GSM-5560-60	55.0	+0.060 +0.180	60.0	60.0	55.180	55.060	60.030	60.000	55.000	54.926
GSM-6065-30	60.0	+0.060 +0.180	65.0	30.0	60.180	60.060	65.030	65.000	60.000	59.926
GSM-6065-40	60.0	+0.060 +0.180	65.0	40.0	60.180	60.060	65.030	65.000	60.000	59.926
GSM-6065-50	60.0	+0.060 +0.180	65.0	50.0	60.180	60.060	65.030	65.000	60.000	59.926
GSM-6065-60	60.0	+0.060 +0.180	65.0	60.0	60.180	60.060	65.030	65.000	60.000	59.926
GSM-6267-35	62.0	+0.060 +0.180	67.0	35.0	62.180	62.060	67.030	67.000	62.000	61.926
GSM-6267-72	62.0	+0.060 +0.180	67.0	72.0	62.180	62.060	67.030	67.000	62.000	61.926
GSM-6570-30	65.0	+0.060 +0.180	70.0	30.0	65.180	65.060	70.030	70.000	65.000	64.926
GSM-6570-50	65.0	+0.060 +0.180	70.0	50.0	65.180	65.060	70.030	70.000	65.000	64.926
GSM-7075-60	70.0	+0.060 +0.180	75.0	60.0	70.180	70.060	75.030	75.000	70.000	69.926
GSM-7277-76	72.0	+0.060 +0.180	77.0	76.0	72.180	72.060	77.030	77.000	72.000	71.926
GSM-7277-78	72.0	+0.060 +0.180	77.0	78.0	72.180	72.060	77.030	77.000	72.000	71.926
GSM-7580-40	75.0	+0.060 +0.180	80.0	40.0	75.180	75.060	80.030	80.000	75.000	74.926
GSM-7580-60	75.0	+0.060 +0.180	80.0	60.0	75.180	75.060	80.030	80.000	75.000	74.926
GSM-8085-60	80.0	+0.060 +0.180	85.0	60.0	80.180	80.060	85.035	85.000	80.000	79.926
GSM-8085-100	80.0	+0.060 +0.180	85.0	100.0	80.180	80.060	85.035	85.000	80.000	79.926

iglide® Plain Bearings G300 - Sleeve Bearing, MM

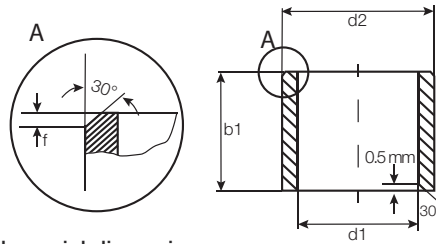

For tolerance values
please refer to page 6.4

Dimensions according to ISO 3547-1 and special dimensions

Part Number	d1	d1-Tolerance after pressfit in Ø H7	d2	b1 h13	I.D. After Pressfit		Housing Bore		Shaft Size	
					Max.	Min.	Max.	Min.	Max.	Min.
GSM-8590-100	85.0	+0.072 +0.212	90.0	100.0	85.212	85.072	90.035	90.000	85.000	84.913
GSM-9095-100	90.0	+0.072 +0.212	95.0	100.0	90.212	90.072	95.035	95.000	90.000	89.913
GSM-95100-100	95.0	+0.072 +0.212	100.0	100.0	95.212	95.072	100.035	100.000	95.000	94.913
GSM-100105-30	100.0	+0.072 +0.212	105.0	30.0	100.212	100.072	105.035	105.000	100.000	99.913
GSM-100105-100	100.0	+0.072 +0.212	105.0	100.0	100.212	100.072	105.035	105.000	100.000	99.913
GSM-110115-100	110.0	+0.072 +0.212	115.0	100.0	110.212	110.072	115.035	115.000	110.000	109.913
GSM-120125-100	120.0	+0.072 +0.212	125.0	100.0	120.212	120.072	125.040	125.000	120.000	119.913
GSM-125130-100	125.0	+0.085 +0.245	130.0	100.0	125.245	125.085	130.040	130.000	125.000	124.900
GSM-130135-100	130.0	+0.085 +0.245	135.0	100.0	130.245	130.085	135.040	135.000	130.000	129.900
GSM-135140-80	135.0	+0.085 +0.245	140.0	80.0	135.245	135.085	140.040	140.000	135.000	134.900
GSM-140145-100	140.0	+0.085 +0.245	145.0	100.0	140.245	140.085	145.040	145.000	140.000	139.900
GSM-150155-100	150.0	+0.085 +0.245	155.0	100.0	150.245	150.085	155.040	155.000	150.000	149.900

iglide® G300
Sleeve - MM

PDF: www.igus.com/iglide-pdfs
CAD: www.igus.com/iglide-CAD
RoHS info: www.igus.com/RoHS

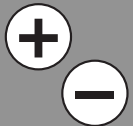

iglide® G300
Flange - MM

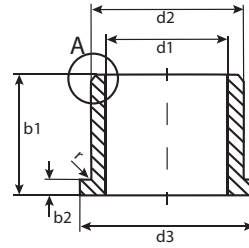
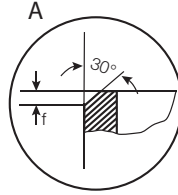

For tolerance values
please refer to page 6.4

r = max. 0.5

Dimensions according to ISO 3547-1 and special dimensions

Part Number	d1 ¹⁾		d2	d3	b1	b2	I.D. After Pressfit		Housing Bore		Shaft Size	
	after Pressfit in Ø H7						Max.	Min.	Max.	Min.	Max.	Min.
GFM-0304-02	3.0	+0.014 +0.054	4.5	7.5	2.0	0.75	3.054	3.014	4.512	4.500	3.000	2.975
GFM-0304-0275	3.0	+0.014 +0.054	4.5	7.5	2.75	0.75	3.054	3.014	4.512	4.500	3.000	2.975
GFM-0304-03	3.0	+0.014 +0.054	4.5	7.5	3.0	0.75	3.054	3.014	4.512	4.500	3.000	2.975
GFM-0304-05	3.0	+0.014 +0.054	4.5	7.5	5.0	0.75	3.054	3.014	4.512	4.500	3.000	2.975
GFM-030407-05	3.0	+0.014 +0.054	4.5	7.0	5.0	0.75	3.054	3.014	4.512	4.500	3.000	2.975
GFM-0405-03	4.0	+0.020 +0.068	5.5	9.5	3.0	0.75	4.068	4.020	5.512	5.500	4.000	3.970
GFM-0405-04	4.0	+0.020 +0.068	5.5	9.5	4.0	0.75	4.068	4.020	5.512	5.500	4.000	3.970
GFM-0405-06	4.0	+0.020 +0.068	5.5	9.5	6.0	0.75	4.068	4.020	5.512	5.500	4.000	3.970
GFM-040508-10	4.0	+0.020 +0.068	5.5	8.0	10.0	0.75	4.068	4.020	5.512	5.500	4.000	3.970
GFM-0506-035	5.0	+0.010 +0.040	6.0	10.0	3.5	0.5	5.040	5.010	6.012	6.000	5.000	4.970
GFM-0506-04	5.0	+0.010 +0.040	6.0	10.0	4.0	0.5	5.040	5.010	6.012	6.000	5.000	4.970
GFM-0506-05	5.0	+0.010 +0.040	6.0	10.0	5.0	0.5	5.040	5.010	6.012	6.000	5.000	4.970
GFM-0506-06	5.0	+0.010 +0.040	6.0	10.0	6.0	0.5	5.040	5.010	6.012	6.000	5.000	4.970
GFM-0506-15	5.0	+0.010 +0.040	6.0	10.0	15.25	0.5	5.040	5.010	6.012	6.000	5.000	4.970
GFM-0507-03	5.0	+0.020 +0.068	7.0	11.0	3.5	1.0	5.068	5.020	7.015	7.000	5.000	4.970
GFM-0507-04	5.0	+0.020 +0.068	7.0	11.0	4.0	1.0	5.068	5.020	7.015	7.000	5.000	4.970
GFM-0507-05	5.0	+0.020 +0.068	7.0	11.0	5.0	1.0	5.068	5.020	7.015	7.000	5.000	4.970
GFM-0507-07	5.0	+0.020 +0.068	7.0	11.0	7.0	1.0	5.068	5.020	7.015	7.000	5.000	4.970
GFM-0507-11	5.0	+0.020 +0.068	7.0	11.0	11.0	1.0	5.068	5.020	7.015	7.000	5.000	4.970
GFM-0507-30	5.0	+0.020 +0.068	7.0	11.0	30.0	1.0	5.068	5.020	7.015	7.000	5.000	4.970
GFM-050715-04	5.0	+0.020 +0.068	7.0	15.0	4.0	1.0	5.068	5.020	7.015	7.000	5.000	4.970
GFM-050709-05	5.0	+0.020 +0.068	7.0	9.0	5.0	1.0	5.068	5.020	7.015	7.000	5.000	4.970
GFM-0607-06	6.0	+0.010 +0.040	7.0	11.0	6.0	0.5	6.040	6.010	7.015	7.000	6.000	5.970
GFM-0607-10	6.0	+0.010 +0.040	7.0	11.0	10.0	0.5	6.040	6.010	7.015	7.000	6.000	5.970
GFM-0607-024	6.0	+0.010 +0.040	7.0	11.0	2.4	0.5	6.040	6.010	7.015	7.000	6.000	5.970
GFM-0608-04	6.0	+0.020 +0.068	8.0	12.0	4.0	1.0	6.068	6.020	8.015	8.000	6.000	5.970
GFM-0608-048	6.0	+0.020 +0.068	8.0	12.0	4.8	1.0	6.068	6.020	8.015	8.000	6.000	5.970
GFM-0608-05	6.0	+0.020 +0.068	8.0	12.0	5.0	1.0	6.068	6.020	8.015	8.000	6.000	5.970
GFM-0608-06	6.0	+0.020 +0.068	8.0	12.0	6.0	1.0	6.068	6.020	8.015	8.000	6.000	5.970
GFM-0608-07	6.0	+0.020 +0.068	8.0	12.0	7.0	1.0	6.068	6.020	8.015	8.000	6.000	5.970
GFM-0608-08	6.0	+0.020 +0.068	8.0	12.0	8.0	1.0	6.068	6.020	8.015	8.000	6.000	5.970
GFM-0608-10	6.0	+0.020 +0.068	8.0	12.0	10.0	1.0	6.068	6.020	8.015	8.000	6.000	5.970
GFM-060810-08	6.0	+0.020 +0.068	8.0	10.0	8.0	1.0	6.068	6.020	8.015	8.000	6.000	5.970
GFM-060812-20	6.0	+0.020 +0.068	8.0	12.0	20.0	1.0	6.068	6.020	8.015	8.000	6.000	5.970
GFM-060814-12	6.0	+0.020 +0.068	8.0	14.0	12.0	1.0	6.068	6.020	8.015	8.000	6.000	5.970
GFM-0708-03	7.0	+0.013 +0.049	8.0	12.0	3.0	0.5	7.049	7.013	8.015	8.000	7.000	6.964
GFM-0708-08	7.0	+0.013 +0.049	8.0	12.0	8.0	0.5	7.049	7.013	8.015	8.000	7.000	6.964
GFM-0709-06	7.0	+0.025 +0.083	9.0	15.0	6.0	1.0	7.083	7.025	9.015	9.000	7.000	6.964
GFM-0709-10	7.0	+0.025 +0.083	9.0	15.0	10.0	1.0	7.083	7.025	9.015	9.000	7.000	6.964
GFM-0709-12	7.0	+0.025 +0.083	9.0	15.0	12.0	1.0	7.083	7.025	9.015	9.000	7.000	6.964

Telephone 1-800-521-2747
Fax 1-401-438-7270

Internet: <http://www.igus.com>
email: sales@igus.com
QuickSpec: <http://www.igus.com/iglide-quickspec>

iglide® Plain Bearings G300 - Flange Bearing, MM



G300

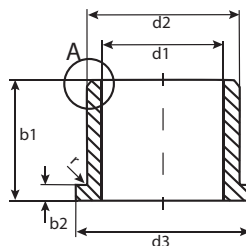
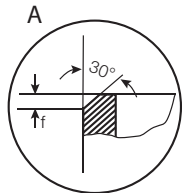

For tolerance values please refer to page 6.4

r = max. 0.5

Dimensions according to ISO 3547-1 and special dimensions

Part Number	d1 ¹⁾		d2	d3	b1	b2	I.D. After Pressfit		Housing Bore		Shaft Size	
	after Pressfit in Ø H7						Max.	Min.	Max.	Min.	Max.	Min.
GFM-070919-10	7.0	+0.025 +0.083	9.0	19.0	10.0	1.0	7.083	7.025	9.015	9.000	7.000	6.964
GFM-0809-03	8.0	+0.013 +0.049	9.0	15.0	3.0	0.5	8.049	8.013	9.015	9.000	8.000	7.964
GFM-0809-035	8.0	+0.013 +0.049	9.0	13.0	3.5	0.5	8.049	8.013	9.015	9.000	8.000	7.964
GFM-0809-055	8.0	+0.013 +0.049	9.0	13.0	5.5	0.5	8.049	8.013	9.015	9.000	8.000	7.964
GFM-0809-08	8.0	+0.013 +0.049	9.0	13.0	8.0	0.5	8.049	8.013	9.015	9.000	8.000	7.964
GFM-0809-12	8.0	+0.013 +0.049	9.0	13.0	12.0	0.5	8.049	8.013	9.015	9.000	8.000	7.964
GFM-0810-02	8.0	+0.025 +0.083	10.0	15.0	2.7	1.0	8.083	8.025	10.015	10.000	8.000	7.964
GFM-0810-03	8.0	+0.025 +0.083	10.0	15.0	3.0	1.0	8.083	8.025	10.015	10.000	8.000	7.964
GFM-0810-035	8.0	+0.025 +0.083	10.0	15.0	3.5	1.0	8.083	8.025	10.015	10.000	8.000	7.964
GFM-0810-04	8.0	+0.025 +0.083	10.0	15.0	4.0	1.0	8.083	8.025	10.015	10.000	8.000	7.964
GFM-0810-05	8.0	+0.025 +0.083	10.0	15.0	5.5	1.0	8.083	8.025	10.015	10.000	8.000	7.964
GFM-0810-06	8.0	+0.025 +0.083	10.0	15.0	6.0	1.0	8.083	8.025	10.015	10.000	8.000	7.964
GFM-0810-065	8.0	+0.025 +0.083	10.0	15.0	6.5	1.0	8.083	8.025	10.015	10.000	8.000	7.964
GFM-0810-07	8.0	+0.025 +0.083	10.0	15.0	7.5	1.0	8.083	8.025	10.015	10.000	8.000	7.964
GFM-0810-09	8.0	+0.025 +0.083	10.0	15.0	9.5	1.0	8.083	8.025	10.015	10.000	8.000	7.964
GFM-0810-10	8.0	+0.025 +0.083	10.0	15.0	10.0	1.0	8.083	8.025	10.015	10.000	8.000	7.964
GFM-0810-11	8.0	+0.025 +0.083	10.0	15.0	11.0	1.0	8.083	8.025	10.015	10.000	8.000	7.964
GFM-0810-15	8.0	+0.025 +0.083	10.0	15.0	15.0	1.0	8.083	8.025	10.015	10.000	8.000	7.964
GFM-0810-25	8.0	+0.025 +0.083	10.0	15.0	25.0	1.0	8.083	8.025	10.015	10.000	8.000	7.964
GFM-0810-30	8.0	+0.025 +0.083	10.0	15.0	30.0	1.0	8.083	8.025	10.015	10.000	8.000	7.964
GFM-081013-08	8.0	+0.025 +0.083	10.0	13.0	8.0	1.0	8.083	8.025	10.015	10.000	8.000	7.964
GFM-081014-05	8.0	+0.025 +0.083	10.0	14.0	5.0	1.0	8.083	8.025	10.015	10.000	8.000	7.964
GFM-081014-06	8.0	+0.025 +0.083	10.0	14.0	6.0	1.0	8.083	8.025	10.015	10.000	8.000	7.964
GFM-081014-08	8.0	+0.025 +0.083	10.0	14.0	8.0	1.0	8.083	8.025	10.015	10.000	8.000	7.964
GFM-081014-10	8.0	+0.025 +0.083	10.0	14.0	10.0	1.0	8.083	8.025	10.015	10.000	8.000	7.964
GFM-081016-11	8.0	+0.025 +0.083	10.0	16.0	11.0	1.0	8.083	8.025	10.015	10.000	8.000	7.964
GFM-081016-15	8.0	+0.025 +0.083	10.0	16.0	15.0	1.0	8.083	8.025	10.015	10.000	8.000	7.964
GFM-081017-15	8.0	+0.025 +0.083	10.0	17.0	15.0	1.0	8.083	8.025	10.015	10.000	8.000	7.964
GFM-0811-07	8.0	+0.025 +0.083	11.0	18.0	7.0	1.0	8.083	8.025	11.018	11.000	8.000	7.964
GFM-0910-065	9.0	+0.013 +0.049	10.0	15.0	6.5	0.5	9.049	9.013	10.015	10.000	9.000	8.964
GFM-0910-17	9.0	+0.013 +0.049	10.0	15.0	17.5	0.5	9.049	9.013	10.015	10.000	9.000	8.964
GFM-1011-026	10.0	+0.013 +0.049	11.0	15.0	2.6	0.5	10.049	10.013	11.015	11.000	10.000	9.964
GFM-1011-03	10.0	+0.013 +0.049	11.0	15.0	3.5	0.5	10.049	10.013	11.015	11.000	10.000	9.964
GFM-1011-044	10.0	+0.013 +0.049	11.0	15.0	4.4	0.5	10.049	10.013	11.015	11.000	10.000	9.964
GFM-1011-10	10.0	+0.013 +0.049	11.0	15.0	10.0	0.5	10.049	10.013	11.015	11.000	10.000	9.964
GFM-1012-035	10.0	+0.025 +0.083	12.0	18.0	3.5	1.0	10.083	10.025	12.018	12.000	10.000	9.964
GFM-1012-04	10.0	+0.025 +0.083	12.0	18.0	4.0	1.0	10.083	10.025	12.018	12.000	10.000	9.964
GFM-1012-05	10.0	+0.025 +0.083	12.0	18.0	5.0	1.0	10.083	10.025	12.018	12.000	10.000	9.964
GFM-1012-06	10.0	+0.025 +0.083	12.0	18.0	6.0	1.0	10.083	10.025	12.018	12.000	10.000	9.964
GFM-101214-06	10.0	+0.025 +0.083	12.0	14.0	6.0	1.0	10.083	10.025	12.018	12.000	10.000	9.964

iglide® G300
Flange - MM

PDF: www.igus.com/iglide-pdfs
CAD: www.igus.com/iglide-CAD
RoHS info: www.igus.com/RoHS

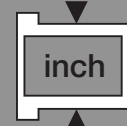

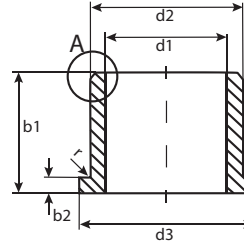
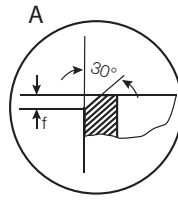

For tolerance values
please refer to page 6.4

r = max. 0.5

Dimensions according to ISO 3547-1 and special dimensions

Part Number	d1 ¹⁾		d2	d3	b1	b2	I.D. After Pressfit		Housing Bore		Shaft Size	
	after Pressfit in Ø H7						Max.	Min.	Max.	Min.	Max.	Min.
GFM-1012-07	10.0	+0.025 +0.083	12.0	18.0	7.0	1.0	10.083	10.025	12.018	12.000	10.000	9.964
GFM-1012-09	10.0	+0.025 +0.083	12.0	18.0	9.0	1.0	10.083	10.025	12.018	12.000	10.000	9.964
GFM-1012-10	10.0	+0.025 +0.083	12.0	18.0	10.0	1.0	10.083	10.025	12.018	12.000	10.000	9.964
GFM-1012-12	10.0	+0.025 +0.083	12.0	18.0	12.0	1.0	10.083	10.025	12.018	12.000	10.000	9.964
GFM-1012-15	10.0	+0.025 +0.083	12.0	18.0	15.0	1.0	10.083	10.025	12.018	12.000	10.000	9.964
GFM-1012-17	10.0	+0.025 +0.083	12.0	18.0	17.0	1.0	10.083	10.025	12.018	12.000	10.000	9.964
GFM-101216-06	10.0	+0.025 +0.083	12.0	16.0	6.0	1.0	10.083	10.025	12.018	12.000	10.000	9.964
GFM-101214-07	10.0	+0.025 +0.083	12.0	14.0	7.0	1.0	10.083	10.025	12.018	12.000	10.000	9.964
GFM-101216-09	10.0	+0.025 +0.083	12.0	16.0	9.0	1.0	10.083	10.025	12.018	12.000	10.000	9.964
GFM-101216-10	10.0	+0.025 +0.083	12.0	16.0	10.0	1.0	10.083	10.025	12.018	12.000	10.000	9.964
GFM-101215-12	10.0	+0.025 +0.083	12.0	15.0	12.0	1.0	10.083	10.025	12.018	12.000	10.000	9.964
GFM-101216-15	10.0	+0.025 +0.083	12.0	16.0	15.0	1.0	10.083	10.025	12.018	12.000	10.000	9.964
GFM-1013-12	10.0	+0.025 +0.083	13.0	18.0	12.0	1.5	10.083	10.025	13.018	13.000	10.000	9.964
GFM-111320-037	11.0	+0.032 +0.102	13.0	20.0	3.7	1.0	11.102	11.032	13.018	13.000	11.000	10.957
GFM-1213-03	12.0	+0.016 +0.059	13.0	17.0	3.0	0.5	12.059	12.016	13.018	13.000	12.000	11.957
GFM-1213-12	12.0	+0.016 +0.059	13.0	17.0	12.0	0.5	12.059	12.016	13.018	13.000	12.000	11.957
GFM-121315-12	12.0	+0.016 +0.059	13.0	15.0	12.0	1.0	12.059	12.016	13.018	13.000	12.000	11.957
GFM-1214-03	12.0	+0.032 +0.102	14.0	20.0	3.0	1.0	12.102	12.032	14.018	14.000	12.000	11.957
GFM-1214-06	12.0	+0.032 +0.102	14.0	20.0	6.0	1.0	12.102	12.032	14.018	14.000	12.000	11.957
GFM-1214-07	12.0	+0.032 +0.102	14.0	20.0	7.0	1.0	12.102	12.032	14.018	14.000	12.000	11.957
GFM-1214-09	12.0	+0.032 +0.102	14.0	20.0	9.0	1.0	12.102	12.032	14.018	14.000	12.000	11.957
GFM-1214-10	12.0	+0.032 +0.102	14.0	20.0	10.0	1.0	12.102	12.032	14.018	14.000	12.000	11.957
GFM-1214-11	12.0	+0.032 +0.102	14.0	20.0	11.0	1.0	12.102	12.032	14.018	14.000	12.000	11.957
GFM-1214-12	12.0	+0.032 +0.102	14.0	20.0	12.0	1.0	12.102	12.032	14.018	14.000	12.000	11.957
GFM-1214-15	12.0	+0.032 +0.102	14.0	20.0	15.0	1.0	12.102	12.032	14.018	14.000	12.000	11.957
GFM-1214-17	12.0	+0.032 +0.102	14.0	20.0	17.0	1.0	12.102	12.032	14.018	14.000	12.000	11.957
GFM-1214-20	12.0	+0.032 +0.102	14.0	20.0	20.0	1.0	12.102	12.032	14.018	14.000	12.000	11.957
GFM-1214-24	12.0	+0.032 +0.102	14.0	20.0	24.0	1.0	12.102	12.032	14.018	14.000	12.000	11.957
GFM-121416-034	12.0	+0.032 +0.102	14.0	16.0	3.4	1.0	12.102	12.032	14.018	14.000	12.000	11.957
GFM-121418-04	12.0	+0.032 +0.102	14.0	18.0	4.0	1.0	12.102	12.032	14.018	14.000	12.000	11.957
GFM-121418-08	12.0	+0.032 +0.102	14.0	18.0	8.0	1.0	12.102	12.032	14.018	14.000	12.000	11.957
GFM-121418-10	12.0	+0.032 +0.102	14.0	18.0	10.0	1.0	12.102	12.032	14.018	14.000	12.000	11.957
GFM-121418-12	12.0	+0.032 +0.102	14.0	18.0	12.0	1.0	12.102	12.032	14.018	14.000	12.000	11.957
GFM-121418-15	12.0	+0.032 +0.102	14.0	18.0	15.0	1.0	12.102	12.032	14.018	14.000	12.000	11.957
GFM-121418-20	12.0	+0.032 +0.102	14.0	18.0	20.0	1.0	12.102	12.032	14.018	14.000	12.000	11.957
GFM-1315-06	13.0	+0.032 +0.102	15.0	22.0	6.0	1.0	13.102	13.032	15.018	15.000	13.000	12.957
GFM-1416-03	14.0	+0.032 +0.102	16.0	22.0	3.0	1.0	14.102	14.032	16.018	16.000	14.000	13.957
GFM-1416-04	14.0	+0.032 +0.102	16.0	22.0	4.0	1.0	14.102	14.032	16.018	16.000	14.000	13.957
GFM-1416-05	14.0	+0.032 +0.102	16.0	22.0	5.0	1.0	14.102	14.032	16.018	16.000	14.000	13.957
GFM-1416-06	14.0	+0.032 +0.102	16.0	22.0	6.0	1.0	14.102	14.032	16.018	16.000	14.000	13.957

iglide® Plain Bearings G300 - Flange Bearing, MM



G300

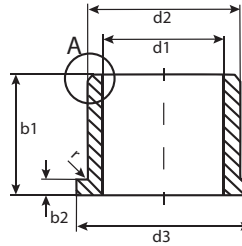
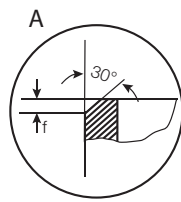

For tolerance values
please refer to page 6.4

r = max. 0.5

Dimensions according to ISO 3547-1 and special dimensions

Part Number	d1 ¹⁾ after Pressfit in Ø H7		d2	d3 d13	b1 h13	b2 -0.14	I.D. After Pressfit		Housing Bore		Shaft Size	
	Max.	Min.					Max.	Min.	Max.	Min.		
GFM-1416-08	14.0	+0.032 +0.102	16.0	22.0	8.0	1.0	14.102	14.032	16.018	16.000	14.000	13.957
GFM-1416-10	14.0	+0.032 +0.102	16.0	22.0	10.0	1.0	14.102	14.032	16.018	16.000	14.000	13.957
GFM-1416-12	14.0	+0.032 +0.102	16.0	22.0	12.0	1.0	14.102	14.032	16.018	16.000	14.000	13.957
GFM-1416-17	14.0	+0.032 +0.102	16.0	22.0	17.0	1.0	14.102	14.032	16.018	16.000	14.000	13.957
GFM-1416-21	14.0	+0.032 +0.102	16.0	22.0	21.0	1.0	14.102	14.032	16.018	16.000	14.000	13.957
GFM-141624-16	14.0	+0.032 +0.102	16.0	24.0	16.0	1.0	14.102	14.032	16.018	16.000	14.000	13.957
GFM-1516-02	15.0	+0.016 +0.059	16.0	20.0	2.0	0.5	15.059	15.016	16.018	16.000	15.000	14.957
GFM-1516-025	15.0	+0.016 +0.059	16.0	20.0	2.5	0.5	15.059	15.016	16.018	16.000	15.000	14.957
GFM-1516-03	15.0	+0.016 +0.059	16.0	20.0	3.0	0.5	15.059	15.016	16.018	16.000	15.000	14.957
GFM-1516-15	15.0	+0.016 +0.059	16.0	20.0	15.0	0.5	15.059	15.016	16.018	16.000	15.000	14.957
GFM-1517-04	15.0	+0.032 +0.102	17.0	23.0	4.0	1.0	15.102	15.032	17.018	17.000	15.000	14.957
GFM-1517-045	15.0	+0.032 +0.102	17.0	23.0	4.5	1.0	15.102	15.032	17.018	17.000	15.000	14.957
GFM-1517-05	15.0	+0.032 +0.102	17.0	23.0	5.0	1.0	15.102	15.032	17.018	17.000	15.000	14.957
GFM-1517-09	15.0	+0.032 +0.102	17.0	23.0	9.0	1.0	15.102	15.032	17.018	17.000	15.000	14.957
GFM-1517-12	15.0	+0.032 +0.102	17.0	23.0	12.0	1.0	15.102	15.032	17.018	17.000	15.000	14.957
GFM-1517-17	15.0	+0.032 +0.102	17.0	23.0	17.0	1.0	15.102	15.032	17.018	17.000	15.000	14.957
GFM-1517-20	15.0	+0.032 +0.102	17.0	23.0	20.0	1.0	15.102	15.032	17.018	17.000	15.000	14.957
GFM-151824-32	15.0	+0.032 +0.102	18.0	24.0	32.0	1.5	15.102	15.032	18.018	18.000	15.000	14.957
GFM-1618-04	16.0	+0.032 +0.102	18.0	24.0	4.0	1.0	16.102	16.032	18.018	18.000	16.000	15.957
GFM-1618-06	16.0	+0.032 +0.102	18.0	24.0	6.0	1.0	16.102	16.032	18.018	18.000	16.000	15.957
GFM-1618-09	16.0	+0.032 +0.102	18.0	24.0	9.0	1.0	16.102	16.032	18.018	18.000	16.000	15.957
GFM-1618-12	16.0	+0.032 +0.102	18.0	24.0	12.0	1.0	16.102	16.032	18.018	18.000	16.000	15.957
GFM-1618-17	16.0	+0.032 +0.102	18.0	24.0	17.0	1.0	16.102	16.032	18.018	18.000	16.000	15.957
GFM-1618-21	16.0	+0.032 +0.102	18.0	24.0	21.0	1.0	16.102	16.032	18.018	18.000	16.000	15.957
GFM-1622-12	16.0	+0.032 +0.102	22.0	25.0	12.0	1.0	16.102	16.032	22.021	22.000	16.000	15.957
GFM-1719-09	17.0	+0.032 +0.102	19.0	25.0	9.0	1.0	17.102	17.032	19.021	19.000	17.000	16.957
GFM-1719-25	17.0	+0.032 +0.102	19.0	25.0	25.0	1.0	17.102	17.032	19.021	19.000	17.000	16.957
GFM-1820-04	18.0	+0.032 +0.102	20.0	26.0	4.0	1.0	18.102	18.032	20.021	20.000	18.000	17.957
GFM-1820-06	18.0	+0.032 +0.102	20.0	26.0	6.0	1.0	18.102	18.032	20.021	20.000	18.000	17.957
GFM-1820-09	18.0	+0.032 +0.102	20.0	26.0	9.0	1.0	18.102	18.032	20.021	20.000	18.000	17.957
GFM-1820-11	18.0	+0.032 +0.102	20.0	26.0	11.0	1.0	18.102	18.032	20.021	20.000	18.000	17.957
GFM-1820-12	18.0	+0.032 +0.102	20.0	26.0	12.0	1.0	18.102	18.032	20.021	20.000	18.000	17.957
GFM-1820-17	18.0	+0.032 +0.102	20.0	26.0	17.0	1.0	18.102	18.032	20.021	20.000	18.000	17.957
GFM-1820-22	18.0	+0.032 +0.102	20.0	26.0	22.0	1.0	18.102	18.032	20.021	20.000	18.000	17.957
GFM-1820-30	18.0	+0.032 +0.102	20.0	26.0	30.0	1.0	18.102	18.032	20.021	20.000	18.000	17.957
GFM-1820-32	18.0	+0.032 +0.102	20.0	26.0	32.0	1.0	18.102	18.032	20.021	20.000	18.000	17.957
GFM-182022-06	18.0	+0.032 +0.102	20.0	22.0	6.0	1.0	18.102	18.032	22.021	22.000	18.000	17.957
GFM-1822-28	18.0	+0.032 +0.102	22.0	26.0	28.0	2.0	18.102	18.032	22.021	22.000	18.000	17.957
GFM-2021-035	20.0	+0.020 +0.072	21.0	25.0	3.5	0.5	20.072	20.020	21.021	21.000	20.000	19.948
GFM-2021-20	20.0	+0.020 +0.072	21.0	25.0	20.0	0.5	20.072	20.020	21.021	21.000	20.000	19.948
GFM-2023-07	20.0	+0.040 +0.124	23.0	30.0	7.0	1.5	20.124	20.040	23.021	23.000	20.000	19.948

iglide® G300
Flange - MM

PDF: www.igus.com/iglide-pdfs
CAD: www.igus.com/iglide-CAD
RoHS info: www.igus.com/RoHS

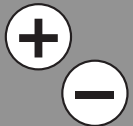

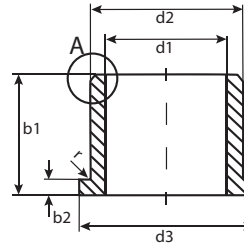
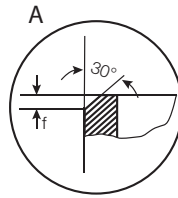

For tolerance values
please refer to page 6.4

$r = \max. 0.5$

Dimensions according to ISO 3547-1 and special dimensions

Part Number	d1 ¹⁾ after Pressfit in Ø H7	d1-Tolerance	d2	d3 d13	b1 h13	b2 -0.14	I.D. After Pressfit		Housing Bore		Shaft Size	
							Max.	Min.	Max.	Min.	Max.	Min.
GFM-2023-11	20.0	+0.040 +0.124	23.0	30.0	11.5	1.5	20.124	20.040	23.021	23.000	20.000	19.948
GFM-2023-16	20.0	+0.040 +0.124	23.0	30.0	16.5	1.5	20.124	20.040	23.021	23.000	20.000	19.948
GFM-2023-21	20.0	+0.040 +0.124	23.0	30.0	21.5	1.5	20.124	20.040	23.021	23.000	20.000	19.948
GFM-202329-20	20.0	+0.040 +0.124	23.0	30.0	20.0	1.5	20.124	20.040	23.021	23.000	20.000	19.948
GFM-202326-21	20.0	+0.040 +0.124	23.0	26.0	21.0	1.5	20.124	20.040	23.021	23.000	20.000	19.948
GFM-202328-15	20.0	+0.040 +0.124	23.0	28.0	15.0	1.5	20.124	20.040	23.021	23.000	20.000	19.948
GFM-2427-07	24.0	+0.040 +0.124	27.0	32.0	7.0	1.5	24.124	24.040	27.021	27.000	24.000	23.948
GFM-2427-10	24.0	+0.040 +0.124	27.0	32.0	10.5	1.5	24.124	24.040	27.021	27.000	24.000	23.948
GFM-2526-25	25.0	+0.020 +0.072	26.0	30.0	25.0	0.5	25.072	25.020	26.021	26.000	25.000	24.948
GFM-2527-48	25.0	+0.040 +0.124	27.0	32.0	48.0	1.0	25.124	25.040	27.021	27.000	25.000	24.948
GFM-2528-11	25.0	+0.040 +0.124	28.0	35.0	11.5	1.5	25.124	25.040	28.021	28.000	25.000	24.948
GFM-2528-16	25.0	+0.040 +0.124	28.0	35.0	16.5	1.5	25.124	25.040	28.021	28.000	25.000	24.948
GFM-2528-21	25.0	+0.040 +0.124	28.0	35.0	21.5	1.5	25.124	25.040	28.021	28.000	25.000	24.948
GFM-2630-12	26.0	+0.040 +0.124	30.0	37.0	12.0	2.0	26.124	26.040	30.021	30.000	26.000	25.948
GFM-2730-20	27.0	+0.040 +0.124	30.0	35.0	20.0	1.5	27.124	27.040	30.021	30.000	27.000	26.948
GFM-2830-10	28.0	+0.040 +0.124	30.0	35.0	10.0	1.0	28.124	28.040	30.021	30.000	28.000	27.948
GFM-2830-36	28.0	+0.040 +0.124	30.0	35.0	36.0	1.0	28.124	28.040	30.021	30.000	28.000	27.948
GFM-283239-20	28.0	+0.040 +0.124	32.0	39.0	20.0	2.0	28.124	28.040	32.025	32.000	28.000	27.948
GFM-3031-20	30.0	+0.040 +0.124	31.0	36.0	20.0	0.5	30.124	30.040	31.025	31.000	30.000	29.948
GFM-3031-30	30.0	+0.040 +0.124	31.0	35.0	30.0	0.5	30.124	30.040	31.025	31.000	30.000	29.948
GFM-3032-04	30.0	+0.040 +0.124	32.0	37.0	4.0	1.0	30.124	30.040	32.025	32.000	30.000	29.948
GFM-3032-12	30.0	+0.040 +0.124	32.0	37.0	12.0	1.0	30.124	30.040	32.025	32.000	30.000	29.948
GFM-3032-17	30.0	+0.040 +0.124	32.0	37.0	17.5	1.0	30.124	30.040	32.025	32.000	30.000	29.948
GFM-3032-22	30.0	+0.040 +0.124	32.0	37.0	22.0	1.0	30.124	30.040	32.025	32.000	30.000	29.948
GFM-3034-09	30.0	+0.040 +0.124	34.0	42.0	9.0	2.0	30.124	30.040	34.025	34.000	30.000	29.948
GFM-3034-16	30.0	+0.040 +0.124	34.0	42.0	16.0	2.0	30.124	30.040	34.025	34.000	30.000	29.948
GFM-3034-20	30.0	+0.040 +0.124	34.0	42.0	20.0	2.0	30.124	30.040	34.025	34.000	30.000	29.948
GFM-3034-26	30.0	+0.040 +0.124	34.0	42.0	26.0	2.0	30.124	30.040	34.025	34.000	30.000	29.940
GFM-3034-37	30.0	+0.040 +0.124	34.0	42.0	37.0	2.0	30.124	30.040	34.025	34.000	30.000	29.948
GFM-303440-10	30.0	+0.040 +0.124	34.0	40.0	10.0	2.0	30.124	30.040	34.025	34.000	30.000	29.948
GFM-3236-16	32.0	+0.050 +0.150	36.0	40.0	16.0	2.0	32.150	32.050	36.025	36.000	32.000	31.938
GFM-3236-26	32.0	+0.050 +0.150	36.0	40.0	26.0	2.0	32.150	32.050	36.025	36.000	32.000	31.938
GFM-343850-35	34.0	+0.050 +0.150	38.0	50.0	35.0	2.0	34.150	34.050	38.025	38.000	34.000	34.938
GFM-3539-058	35.0	+0.050 +0.150	39.0	47.0	5.8	2.0	35.150	35.050	39.025	39.000	35.000	34.938
GFM-3539-07	35.0	+0.050 +0.150	39.0	47.0	7.0	2.0	35.150	35.050	39.025	39.000	35.000	34.938
GFM-3539-16	35.0	+0.050 +0.150	39.0	47.0	16.0	2.0	35.150	35.050	39.025	39.000	35.000	34.938
GFM-3539-26	35.0	+0.050 +0.150	39.0	47.0	26.0	2.0	35.150	35.050	39.025	39.000	35.000	34.938
GFM-3539-36	35.0	+0.050 +0.150	39.0	47.0	36.0	2.0	35.150	35.050	39.025	39.000	35.000	34.938
GFM-354051-30	35.0	+0.050 +0.150	40.0	51.0	30.0	2.5	35.150	35.050	40.025	40.000	35.000	34.938
GFM-3842-22	38.0	+0.050 +0.150	42.0	54.0	22.0	2.0	38.150	38.050	42.025	42.000	38.000	37.938
GFM-4044-07	40.0	+0.050 +0.150	44.0	52.0	7.0	2.0	40.150	40.050	44.025	44.000	40.000	39.938
GFM-4044-14	40.0	+0.050 +0.150	44.0	52.0	14.0	2.0	40.150	40.050	44.025	44.000	40.000	39.938

iglide® Plain Bearings G300 - Flange Bearing, MM

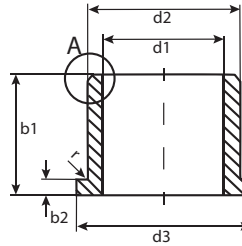
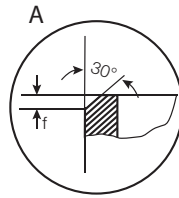

For tolerance values
please refer to page 6.4

r = max. 0.5

Dimensions according to ISO 3547-1 and special dimensions

Part Number	d1 ¹⁾ after Pressfit in Ø H7	d1-Tolerance	d2	d3 d13	b1 h13	b2 -0.14	I.D. After Pressfit		Housing Bore		Shaft Size	
							Max.	Min.	Max.	Min.	Max.	Min.
GFM-4044-20	40.0	+0.050 +0.150	44.0	52.0	20.0	2.0	40.150	40.050	44.025	44.000	40.000	39.938
GFM-4044-30	40.0	+0.050 +0.150	44.0	52.0	30.0	2.0	40.150	40.050	44.025	44.000	40.000	39.938
GFM-4044-40	40.0	+0.050 +0.150	44.0	52.0	40.0	2.0	40.150	40.050	44.025	44.000	40.000	39.938
GFM-4044-50	40.0	+0.050 +0.150	44.0	52.0	50.0	2.0	40.150	40.050	44.025	44.000	40.000	39.938
GFM-4246-19	42.0	+0.050 +0.150	46.0	53.0	19.0	2.0	42.150	42.050	46.025	46.000	42.000	41.938
GFM-4550-30	45.0	+0.050 +0.150	50.0	58.0	30.0	2.0	45.150	45.050	50.025	50.000	45.000	44.938
GFM-4550-50	45.0	+0.050 +0.150	50.0	58.0	50.0	2.0	45.150	45.050	50.025	50.000	45.000	44.938
GFM-5055-07	50.0	+0.050 +0.150	55.0	63.0	7.0	2.0	50.150	50.050	55.030	55.000	50.000	49.938
GFM-5055-10	50.0	+0.050 +0.150	55.0	63.0	10.0	2.0	50.150	50.050	55.030	55.000	50.000	49.938
GFM-5055-18	50.0	+0.050 +0.150	55.0	63.0	18.0	2.0	50.150	50.050	55.030	55.000	50.000	49.938
GFM-5055-25	50.0	+0.050 +0.150	55.0	63.0	25.0	2.0	50.150	50.050	55.030	55.000	50.000	49.938
GFM-5055-40	50.0	+0.050 +0.150	55.0	63.0	40.0	2.0	50.150	50.050	55.030	55.000	50.000	49.938
GFM-5055-50	50.0	+0.050 +0.150	55.0	63.0	50.0	2.0	50.150	50.050	55.030	55.000	50.000	49.938
GFM-6065-07	60.0	+0.060 +0.180	65.0	73.0	7.0	2.0	60.180	60.060	65.030	65.000	60.000	59.926
GFM-6065-22	60.0	+0.060 +0.180	65.0	73.0	22.0	2.0	60.180	60.060	65.030	65.000	60.000	59.926
GFM-6065-30	60.0	+0.060 +0.180	65.0	73.0	30.0	2.0	60.180	60.060	65.030	65.000	60.000	59.926
GFM-6065-50	60.0	+0.060 +0.180	65.0	73.0	50.0	2.0	60.180	60.060	65.030	65.000	60.000	59.926
GFM-606580-62	60.0	+0.060 +0.180	65.0	80.0	62.0	2.0	60.180	60.060	65.030	65.000	60.000	59.926
GFM-6570-50	65.0	+0.060 +0.180	70.0	78.0	50.0	2.0	65.180	65.060	70.030	70.000	65.000	64.926
GFM-7075-50	70.0	+0.060 +0.180	75.0	83.0	50.0	2.0	70.180	70.060	75.030	75.000	70.000	69.926
GFM-7580-50	75.0	+0.060 +0.180	80.0	88.0	50.0	2.0	75.180	75.060	80.030	80.000	75.000	74.926
GFM-8085-100	80.0	+0.060 +0.180	85.0	93.0	100.0	2.5	80.180	80.060	85.035	85.000	80.000	79.926
GFM-8590-100	85.0	+0.072 +0.212	90.0	98.0	100.0	2.5	85.212	85.072	90.035	90.000	85.000	84.913
GFM-9095-100	90.0	+0.072 +0.212	95.0	103.0	100.0	2.5	90.212	90.072	95.035	95.000	90.000	89.913
GFM-95100-100	95.0	+0.072 +0.212	100.0	108.0	100.0	2.5	95.212	95.072	100.035	100.000	95.000	94.913
GFM-100105-42.5	100.0	+0.072 +0.212	105.0	113.0	42.5	2.5	100.212	100.072	105.035	105.000	100.000	99.913
GFM-100105-100	100.0	+0.072 +0.212	105.0	113.0	100.0	2.5	100.212	100.072	105.035	105.000	100.000	99.913
GFM-110115-100	110.0	+0.072 +0.212	115.0	123.0	100.0	2.5	110.212	110.072	115.035	115.000	110.000	109.913
GFM-120125-100	120.0	+0.072 +0.212	125.0	133.0	100.0	2.5	120.212	120.072	125.040	125.000	120.000	119.913
GFM-125130-100	125.0	+0.085 +0.245	130.0	138.0	100.0	2.5	125.245	125.085	130.040	130.000	125.000	124.900
GFM-130135-100	130.0	+0.085 +0.245	135.0	143.0	100.0	2.5	130.245	130.085	135.040	135.000	130.000	129.900
GFM-140145-100	140.0	+0.085 +0.245	145.0	153.0	100.0	2.5	140.245	140.085	145.040	145.000	140.000	139.900
GFM-150155-40	150.0	+0.085 +0.245	155.0	163.0	40.0	2.5	150.245	150.085	155.040	155.000	150.000	149.900
GFM-150155-100	150.0	+0.085 +0.245	155.0	163.0	100.0	2.5	150.245	150.085	155.040	155.000	150.000	149.900

iglide® G300
Flange - MM

PDF: www.igus.com/iglide-pdfs
CAD: www.igus.com/iglide-CAD
RoHS info: www.igus.com/RoHS

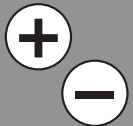

iglide® G300

Thrust Washer - MM

Telephone 1-800-521-2747

Fax 1-401-438-7270

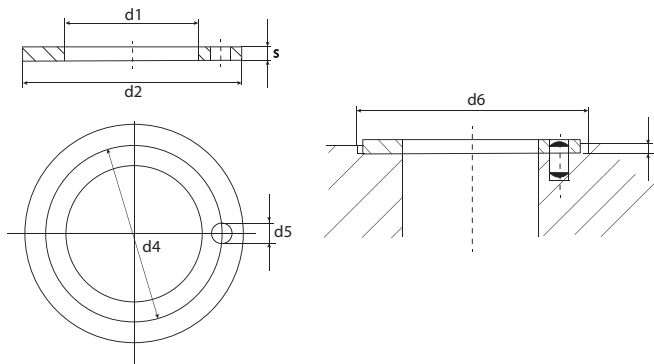
Internet: <http://www.igus.com>email: sales@igus.comQuickSpec: <http://www.igus.com/iglide-quickspec>

Part Number	d1 +0.25	d2 -0.25	s -0.05	d4 -0.12 +0.12	d5 +0.375 +0.125	h +0.2 -0.2	d6 +0.12
GTM-0509-006	5.0	9.5	0.6	*	*	0.3	9.5
GTM-0615-015	6.0	15.0	1.5	*	*	1.0	15
GTM-0620-015	6.0	20.0	1.5	13.0	1.5	1.0	20
GTM-0713-005	7.0	13.0	0.5	*	*	0.2	13
GTM-0815-005	8.0	15.0	0.5	*	*	0.2	15
GTM-0815-015	8.0	15.0	1.5	11.5	*	1.0	15
GTM-0818-010	8.0	18.0	1.0	*	*	0.7	18
GTM-0818-015	8.0	18.0	1.5	13.0	1.5	1.0	18
GTM-0918-015	9.0	18.0	1.5	13.5	1.5	1.0	18
GTM-1018-010	10.0	18.0	1.0	*	*	0.7	18
GTM-1018-020	10.0	18.0	2.0	*	*	1.5	18
GTM-1224-015	12.0	24.0	1.5	18.0	1.5	1.0	24
GTM-1420-015	14.0	20.0	1.5	*	*	1.0	20
GTM-1426-015	14.0	26.0	1.5	20.0	2.0	1.0	26
GTM-1522-008	15.0	22.0	0.8	*	*	0.5	22
GTM-1524-015	15.0	24.0	1.5	19.5	1.5	1.0	24
GTM-1524-0275	15.0	24.0	2.75	*	*	2.0	24
GTM-1630-015	16.0	30.0	1.5	22.0	2.0	1.0	30
GTM-1832-015	18.0	32.0	1.5	25.0	2.0	1.0	32
GTM-2036-015	20.0	36.0	1.5	28.0	3.0	1.0	36
GTM-2238-015	22.0	38.0	1.5	30.0	3.0	1.0	38
GTM-2442-015	24.0	42.0	1.5	33.0	3.0	1.0	42
GTM-2644-015	26.0	44.0	1.5	35.0	3.0	1.0	44
GTM-2835-005	28.0	35.0	0.5	*	*	0.2	35
GTM-2848-015	28.0	48.0	1.5	38.0	4.0	1.0	48
GTM-3254-015	32.0	54.0	1.5	43.0	4.0	1.0	54
GTM-3862-015	38.0	62.0	1.5	50.0	4.0	1.0	62
GTM-4266-015	42.0	66.0	1.5	54.0	4.0	1.0	66
GTM-4874-020	48.0	74.0	2.0	61.0	4.0	1.5	74
GTM-5278-020	52.0	78.0	2.0	65.0	4.0	1.5	78
GTM-6290-020	62.0	90.0	2.0	76.0	4.0	1.5	90
GTM-6881-020	68.0	81.0	2.0	*	*	1.5	81

* Designed without fixing bore